

 fashiontv

ACACIA

BY BNW DEVELOPMENTS

AL MARJAN ISLAND

The background of the slide is a close-up, slightly blurred photograph of several blue fern fronds. The fronds are long and feathery, with many small leaflets. They are arranged diagonally across the frame, creating a sense of movement and texture. The colors range from a deep, dark blue to a lighter, almost white-blue at the tips of the fronds.

UNIT PLANS



1BHK- TYPE A

UNIT 109

1	Kitchen	2.5mx2.5m
2	Living	3.7mx5.9m
3	PWD Room	1.3mx2m
4	Bedroom	3mx5.7m
5	Bath	1.6mx2.6m
6	Dress	1.7mx1.6m
7	Balcony	7mx2m

Suite Area	57.7 sq.m	to	62.09 sq.m
	621.08 sq.ft	to	668.33 sq.ft
Balcony Area	5.48 sq.m	to	44.56 sq.m
	58.99 sq.ft	to	479.64 sq.ft
Total Area	58.39 sq.m	to	103.89 sq.m
	628.5 sq.ft	to	1118.26 sq.ft

Level G , 1 , 2 , 3 , 4 , 5 , 6 , 7 , 8 , 9 , 10 , 11 , 12

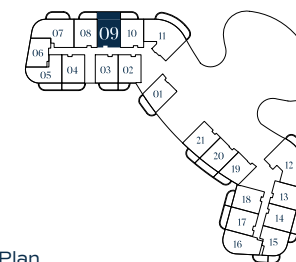

Key Plan





1BHK- TYPE B

UNIT 201

1	Kitchen	2.5mx2.7m
2	Living	3.7mx6.1m
3	PWD Room	1.3mx1.7m
4	Bedroom	3mx6.2m
5	Bath	1.6mx2.6m
6	Dress	1.7mx1.6m
7	Balcony	8.2mx2m

Suite Area	55.49 sq.m	to	59.87 sq.m
	597.29 sq.ft	to	644.44 sq.ft
Balcony Area	5.61 sq.m	to	26.46 sq.m
	60.39 sq.ft	to	284.81 sq.ft
Total Area	61.1 sq.m	to	85.45 sq.m
	657.67 sq.ft	to	919.78 sq.ft

Level G , 1 , 2 , 3 , 4 , 5 , 6 , 7 , 8 , 9 , 10 , 11 , 12

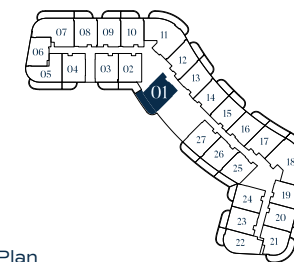

Key Plan



1BHK - TYPE C

UNIT 212

1	Kitchen	2.5mx2.7m
2	Living	3.7mx5.7m
3	PWD Room	1.2mx2.1m
4	Bedroom	3mx6.3m
5	Bath	1.7mx2.8m
6	Dress	1.7mx2m
7	Balcony	5.2mx2m

Suite Area	60.8 sq.m	to	60.81 sq.m
	654.45 sq.ft	to	654.55 sq.ft
Balcony Area	9.24 sq.m	to	14.87 sq.m
	99.46 sq.ft	to	160.06 sq.ft
Total Area	70.04 sq.m	to	75.68 sq.m
	753.9 sq.ft	to	814.61 sq.ft

Level 2, 3, 4, 5, 6, 7, 8

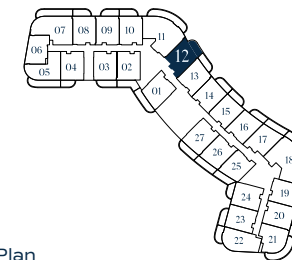

Key Plan



1BHK - TYPE D

UNIT 205



1	Kitchen	2.5mx2.7m
2	Living	3.4mx5.7m
3	PWD Room	1.5mx1.4m
4	Bedroom	4mx4.6m
5	Bath	3.2mx1.7m
6	Dress	1.6mx2.7m
7	Balcony	14.1mx2m

Suite Area	63.8 sq.m	
	686.74 sq.ft	
Balcony Area	8.44 sq.m	to 72.43 sq.m
	90.85 sq.ft	to 779.63 sq.ft
Total Area	72.24 sq.m	to 136.23 sq.m
	777.58 sq.ft	to 1466.37 sq.ft

Level G , 1 , 2 , 3 , 4

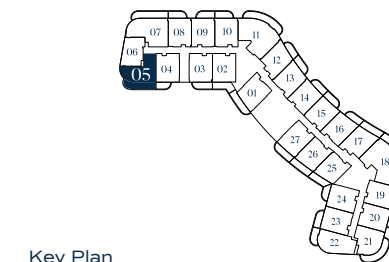

Key Plan



1BHK - TYPE E

UNIT 221



1	Kitchen	2.5mx2.5m
2	Living	3.8mx5.9m
3	PWD Room	1.3mx1.4m
4	Bedroom	4.1mx4.4m
5	Bath	2.6mx1.8m
6	Balcony	8.9mx2m

Suite Area	60.01 sq.m	
	645.94 sq.ft	
Balcony Area	11.45 sq.m	to 26.15 sq.m
	123.25 sq.ft	to 281.48 sq.ft
Total Area	71.46 sq.m	to 86.16 sq.m
	769.19 sq.ft	to 927.42 sq.ft

Level 1, 2, 3, 4

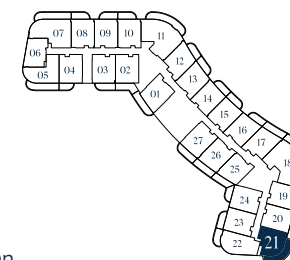

Key Plan



1BHK - TYPE F

UNIT 222



1	Kitchen	2.6mx2.6m
2	Living	4.3mx5.8m
3	PWD Room	1.8mx1.5m
4	Bedroom	4.7mx4.4m
5	Bath	2.5mx1.7m
6	Dress	2mx1.7m
7	Balcony	2mx5.1m

Suite Area	66.37 sq.m	to	66.38 sq.m
	714.4 sq.ft	to	714.51 sq.ft
Balcony Area	8.61 sq.m	to	10.6 sq.m
	92.68 sq.ft	to	114.1 sq.ft
Total Area	74.98 sq.m	to	76.98 sq.m
	807.08 sq.ft	to	828.61 sq.ft

Level 1, 2, 3, 4

Key Plan

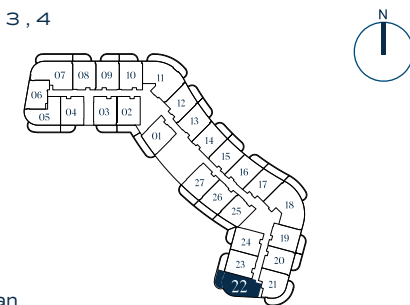

1BHK - TYPE G

UNIT 206



1	Kitchen	2.7mx2.5m
2	Living	5mx3.5m
3	PWD Room	1.7mx1.3m
4	Bedroom	3.4mx3.6m
5	Bath	1.6mx2.4m
6	Dress	1.7mx1.6m

Suite Area	55 sq.m
	592.02 sq.ft
Balcony Area	0.00 sq.m
	0.00 sq.ft
Total Area	55 sq.m
	592.02 sq.ft

Level 1, 2, 3, 4

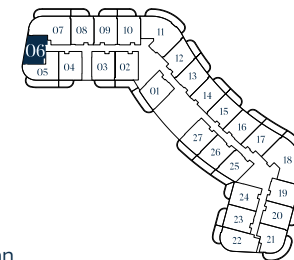

Key Plan



1BHK - TYPE H

UNIT 516



1	Kitchen	2.5mx3m
2	Living	3.4mx5.4m
3	PWD Room	1.7mx1.5m
4	Bedroom	7.1mx3.8m
5	Bath	1.6mx3m
6	Balcony	5.4mx2m

Suite Area	68.05 sq.m	
	732.48 sq.ft	
Balcony Area	10.58 sq.m	to 20.31 sq.m
	113.88 sq.ft	to 218.62 sq.ft
Total Area	78.63 sq.m	to 88.36 sq.m
	846.37 sq.ft	to 951.1 sq.ft

Level 5 , 6

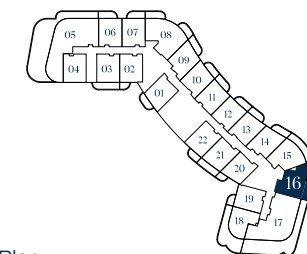

Key Plan



1BHK - TYPE I

UNIT 518



1	Kitchen	2.4mx2.7m
2	Living	3.5mx5.6m
3	PWD Room	1.6mx1.3m
4	Bedroom	3.3mx5.4m
5	Bath	1.6mx2.6m
6	Dress	1.6mx1.6m
7	Balcony -1	11.9mx2m
8	Balcony -2	4.3mx7.8m

Suite Area	57.66 sq.m	to	58.54 sq.m
	620.65 sq.ft	to	630.12 sq.ft
Balcony Area	6.44 sq.m	to	50.48 sq.m
	69.32 sq.ft	to	543.36 sq.ft
Total Area	64.4 sq.m	to	109.02 sq.m
	693.2 sq.ft	to	1173.48 sq.ft

Level 5 , 6 , 7 , 8

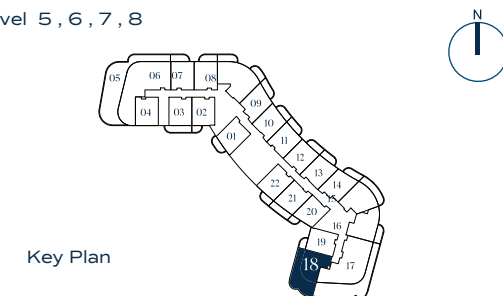

Key Plan

1BHK - TYPE J

UNIT 515



1	Kitchen	2.5mx2.7m
2	Living	3.7mx6.1m
3	PWD Room	2mx1.4m
4	Bedroom	5.6mx6.3m
5	Bath	2.7mx1.7m
6	Balcony	9.8mx2.1m

Suite Area	68.76 sq.m	
	740.13 sq.ft	
Balcony Area	17.01 sq.m	to 20.41 sq.m
	183.09 sq.ft	to 219.69 sq.ft
Total Area	85.77 sq.m	to 89.17 sq.m
	923.22 sq.ft	to 959.82 sq.ft

Level 5 , 6

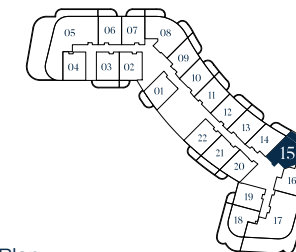

Key Plan



2BHK - TYPE A

UNIT 211



1	Kitchen	2.4mx2.7m
2	Living	3.7mx5.9m
3	PWD Room	1.6mx1.9m
4	Bedroom -1	5.6mx5.2m
5	Bath -1	1.7mx2.6m
6	Dress -1	1.7mx2m
7	Bedroom -2	3.4mx3.7m
8	Bath -2	1.7mx2.7m
9	Dress -2	1.6mx2.7m
10	Laundry	1.6mx1.5m
11	Balcony	12.1mx2m

Suite Area	101.28 sq.m	to	102.17 sq.m
	1090.17 sq.ft	to	1099.75 sq.ft
Balcony Area	22.09 sq.m	to	134.81 sq.m
	237.77 sq.ft	to	1451.08 sq.ft
Total Area	124.05 sq.m	to	236.09 sq.m
	1335.26 sq.ft	to	2541.25 sq.ft

Level G , 1 , 2 , 3 , 4 , 5 , 6 , 7 , 8

Key Plan

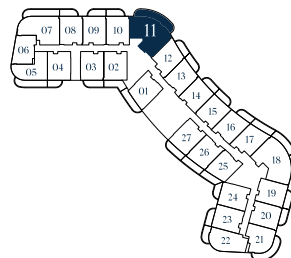

2BHK - TYPE B

UNIT 207



1	Kitchen	2.5mx2.7m
2	Living	3.7mx5.7m
3	PWD Room	2mx1.3m
4	Bedroom -1	4.7mx3.8m
5	Bath -1	2.6mx1.6m
6	Dress -1	3.1mx1.6m
7	Bedroom -2	3.9mx4.2m
8	Bath -2	1.7mx2.6m
9	Balcony	11mx2m

Suite Area	87.85sq.m	
	945.61 sq.ft	
Balcony Area	11.2 sq.m	to 22.57 sq.m
	120.56 sq.ft	to 242.94 sq.ft
Total Area	99.05 sq.m	to 110.42 sq.m
	1066.17 sq.ft	to 1188.55 sq.ft

Level 1, 2, 3, 4

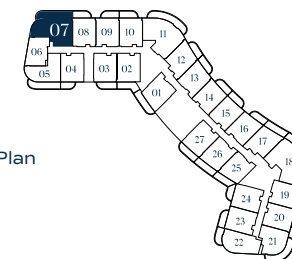

Key Plan

2BHK - TYPE C

UNIT 714

1	Kitchen	2.5mx2.6m
2	Living	4.4mx7.5m
3	PWD Room	1.6mx1.9m
4	Bedroom -1	4.8mx5.7m
5	Bath -1	2.3mx2.7m
6	Dress -1	2.3mx2.4m
7	Bedroom -2	3.3mx5.3m
8	Bath -2	2mx3.1m
9	Balcony -1	6.6mx13.5m
10	Balcony -2	11.8mx2m

Suite Area	116.01 sq.m	
	1248.72 sq.ft	
Balcony Area	74.39 sq.m	to 114.12 sq.m
	800.73 sq.ft	to 1228.38 sq.ft
Total Area	190.4 sq.m	to 230.13 sq.m
	2049.45 sq.ft	to 2477.1 sq.ft



Level 7, 8

Key Plan

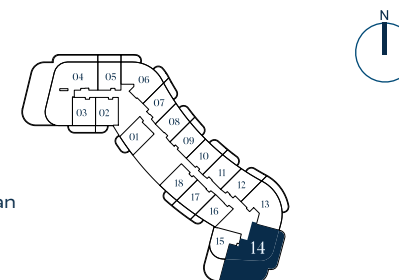

2BHK - TYPE D

UNIT 218



Level 1, 2, 3, 4, 7, 8

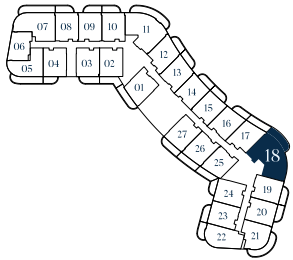

Key Plan

1	Kitchen	2.5mx2.7m
2	Living	3.8mx6m
3	PWD Room	1.5mx1.7m
4	Bedroom -1	6.6mx4.4m
5	Bath -1	1.9mx2.6m
6	Dress -1	1.9mx1.8m
7	Bedroom -2	3.4mx4m
8	Bath -2	1.7mx2.8m
9	Dress -2	1.6mx2.8m
10	Laundry	1.7mx1.7m
11	Balcony	8.1mx2m

Suite Area	106.77 sq.m	to	107.48 sq.m
	1149.26 sq.ft	to	1156.91 sq.ft
Balcony Area	16.94 sq.m	to	34.14 sq.m
	182.34 sq.ft	to	367.48 sq.ft
Total Area	123.71 sq.m	to	140.92 sq.m
	1331.6 sq.ft	to	1516.85 sq.ft

2BHK - TYPE E

UNIT 904

1	Kitchen	2.4mx3.1m
2	Living	5.5mx7.6m
3	PWD Room	1.5mx2.3m
4	Bedroom -1	3.4mx5m
5	Bath -1	1.7mx2.7m
6	Dress -1	1.5mx3.3m
7	Bedroom -2	3.8mx5.3m
8	Bath -2	2.7mx1.7m
9	Store	2.4mx1.7m
10	Balcony -1	10.6mx2m
11	Balcony -2	6.8mx2m

Suite Area	108.22 sq.m
	1164.87 sq.ft
Balcony Area	34.97 sq.m to 35.56 sq.m
	376.41 sq.ft to 382.76 sq.ft
Total Area	143.19 sq.m to 143.78 sq.m
	1541.28 sq.ft to 1547.64 sq.ft



Level 9 , 10

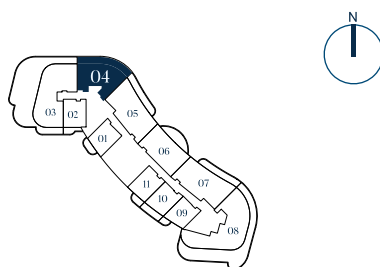

Key Plan

3BHK - TYPE A

UNIT 6006



1	Kitchen	3.1mx2.5m
2	Living	5.7mx4.6m
3	PWD Room	1.7mx1.7m
4	Bedroom -1	3.6mx5.2m
5	Bath -1	2mx2.9m
6	Dress -1	2mx2.6m
7	Bedroom -2	5.7mx3.6m
8	Bath -2	1.6mx2.5m
9	Bedroom -3	5.5mx3.4m
10	Bath -3	2.8mx1.7m
11	Dress -3	2.8mx1.6m
12	Maid Room	2.6mx2.5m
13	Bath -4	1.5mx1.5m
14	Laundry	1.3mx2.3m
15	Balcony -1	19.8mx4m
16	Balcony -2	6.3mx12.6m

Level G



Key Plan

Suite Area	143.49 sq.m
	1544.51 sq.ft
Balcony Area	159.5 sq.m
	1716.84 sq.ft
Total Area	302.99 sq.m
	3261.36 sq.ft



Level 5, 6

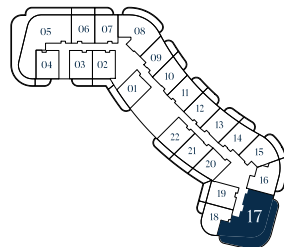

Key Plan



3BHK - TYPE B

UNIT 617

1	Kitchen	2.4mx3.5m
2	Living	3.6mx7.8m
3	PWD Room	1.3mx1.9m
4	Bedroom -1	4.1mx5.1m
5	Bath -1	2mx3.6m
6	Dress -1	1.5mx3.6m
7	Bedroom -2	4.4mx3.1m
8	Bath -2	2.4mx1.6m
9	Dress -2	3.5mx1.9m
10	Bedroom -3	3.5mx5.1m
11	Bath -3	2.6mx1.6m
12	Maid Room	2.5mx1.9m
13	Bath -4	1.9mx1.3m
14	Store	1.7mx1.6m
15	Balocony -1	12.8mx2m
16	Balcony -2	3.2mx12.8m

Suite Area	142.11 sq.m	to	142.12 sq.m
	1529.66 sq.ft	to	1529.77 sq.ft
Balcony Area	62.82 sq.m	to	94.37 sq.m
	676.19 sq.ft	to	1015.79 sq.ft
Total Area	204.94 sq.m	to	236.48 sq.m
	2205.96 sq.ft	to	2545.45 sq.ft

3BHK - TYPE C

UNIT 605

1	Kitchen	3.1mx4.3m
2	Living	4mx6.9m
3	PWD Room	2.3mx1.4m
4	Bedroom -1	5.1mx4.4m
5	Bath -1	3mx2.8m
6	Dress -1	3.7mx2.3m
7	Bedroom -2	5.3mx3m
8	Bath -2	2.6mx1.6m
9	Dress -2	1.8mx1.6m
10	Bedroom -3	4.1mx4.3m
11	Bath -3	1.6mx2.6m
12	Dress -3	1.6mx1.7m
13	Maid Room	2mx2.4m
14	Bath -4	2mx1.5m
15	Store	2mx1.6m
16	Laundry	1mx1.8m
17	Balcony -1	13.5mx2m
18	Balcony -2	4.6mx19.2m
19	Balcony -3	5.2mx2m

Suite Area	166.71 sq.m		
	1794.45 sq.ft		
Balcony Area	102.75 sq.m	to	135.59 sq.m
	1105.99 sq.ft	to	1459.48 sq.ft
Total Area	269.46 sq.m	to	302.3 sq.m
	2900.44 sq.ft	to	3253.93 sq.ft



Level 5 , 6

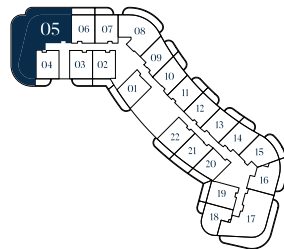

Key Plan





3BHK - TYPE D

UNIT 1006

1	Kitchen	2.4mx2.7m
2	Living	3.7mx5.7m
3	PWD Room	1.1mx1.9m
4	Bedroom -1	3mx4.1m
5	Bath -1	1.7mx2.5m
6	Dress -1	3mx1.6m
7	Bedroom -2	3.8mx3.3m
8	Bath -2	2.6mx1.5m
9	Bedroom -3	3.1mx4.8m
10	Bath -3	1.7mx2.5m
11	Maid Room	2mx1.9m
12	Bath -4	2mx1.3m
13	Balcony	14.1mx3.2m

Level 9 , 10

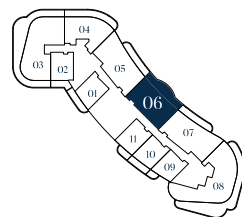

Key Plan

Suite Area	116.85 sq.m	
	1257.76 sq.ft	
Balcony Area	26.42 sq.m	to 35.1 sq.m
	284.38 sq.ft	to 377.81 sq.ft
Total Area	143.27 sq.m	to 151.95 sq.m
	1542.15 sq.ft	to 1635.58 sq.ft

3BHK - TYPE E

UNIT 1007



1	Kitchen	3mx3m
2	Living	3.4mx6.9m
3	PWD Room	2.1mx1.5m
4	Bedroom -1	3.2mx4.4m
5	Bath -1	2.2mx2.4m
6	Dress -1	3.2mx1.6m
7	Bedroom -2	3.4mx4.4m
8	Bath -2	1.7mx2.6m
9	Dress -2	1.6mx2.5m
10	Bedroom -3	3.4mx4.8m
11	Bath -3	1.7mx2.6m
12	Dress -3	1.6mx2.7m
13	Maid Room	2.4mx4.1m
14	Bath -4	1.3mx1.7m
15	Store	1.3mx1.5m
16	Laundry	1mx1.5m
17	Balcony	11.9mx2m

Level 9 , 10

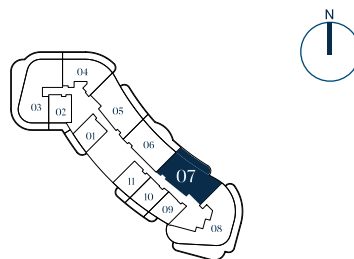

Key Plan

Suite Area	144.16 sq.m	to	145.12 sq.m
	1551.73 sq.ft	to	1562.06 sq.ft
Balcony Area	23.71 sq.m	to	28.43 sq.m
	255.21 sq.ft	to	306.02 sq.ft
Total Area	167.87 sq.m	to	173.55 sq.m
	1806.94 sq.ft	to	1868.08 sq.ft



Level 7, 8

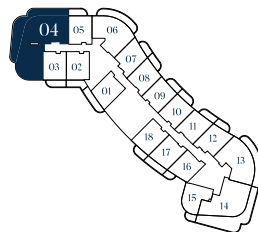

Key Plan



3BHK - TYPE F

UNIT 804

1	Kitchen	3.1mx3.2m
2	Living	5.8mx6.1m
3	PWD Room	2.4mx1.6m
4	Bedroom -1	4.5mx5.6m
5	Bath -1	2.6mx2.8m
6	Dress -1	2.4mx2.1m
7	Bedroom -2	6.1mx3.8m
8	Bath -2	2.9mx1.8m
9	Dress -2	2.2mx1.8m
10	Bedroom -3	5.1mx4.6m
11	Bath -3	2.8mx2.3m
12	Dress -3	2.8mx2.1m
13	Maid Room	2.6mx2.1m
14	Bath -4	1.4mx1.8m
15	Laundry	1.2mx1.8m
16	Store	1.4mx1m
17	Balcony -1	12.2mx2m
18	Balcony -2	3mx13.8m

Suite Area	191.62 sq.m	
	2062.58 sq.ft	
Balcony Area	63.83 sq.m	to 156.58 sq.m
	687.06 sq.ft	to 1685.41 sq.ft
Total Area	255.45 sq.m	to 348.2 sq.m
	2749.64 sq.ft	to 3747.99 sq.ft

Disclaimer: All dimensions, materials and drawings are approximate. Information is subject to change without notice, at the developer's absolute discretion. The actual area may vary from the stated area. Drawings are not to scale. All images used are for illustrative purposes only and do not represent the actual size, features, specifications, fittings and furnishings. The developer reserves the right to make revisions/alterations, at the absolute discretion without any liability whatsoever.

3BHK - TYPE G

UNIT 1105



Level 11

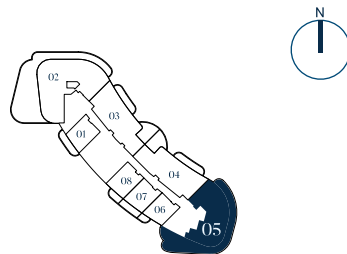

Key Plan



1	Kitchen	2.5mx2.6m
2	Living	8.1mx7.8m
3	PWD Room	2.4mx1.4m
4	Bedroom -1	4.5mx4.9m
5	Bath -1	2.3mx3m
6	Dress -1	2.3mx2.5m
7	Bedroom -2	5.1mx3.4m
8	Bath -2	1.7mx2.8m
9	Dress -2	1.4mx1.9m
10	Bedroom -3	5mx4m
11	Bath -3	2.7mx1.6m
12	Maid Room	2.4mx3.7m
13	Bath -4	1.3mx1.6m
14	Laundry	1.3mx1m
15	Balcony -1	9.4mx2m
16	Balcony -2	13.5mx2m
17	Balcony -3	5.9mx18.4m

Suite Area	167.38 sq.m
	1801.66 sq.ft
Balcony Area	118.33 sq.m
	1273.69 sq.ft
Total Area	285.71 sq.m
	3075.36 sq.ft

3BHK - TYPE H

UNIT 1003



1	Kitchen	3mx3.7m
2	Living	10.8mx5.2m
3	PWD Room	1.4mx2m
4	Bedroom -1	3.5mx6.2m
5	Bath -1	2mx4m
6	Dress -1	2.3mx2.2m
7	Bedroom -2	3.3mx4.1m
8	Bath -2	1.7mx1.9m
9	Dress -2	1.7mx1.6m
10	Bedroom -3	4.6mx4.4m
11	Bath -3	1.6mx2.6m
12	Maid Room	2.4mx2.7m
13	Bath -4	1.8mx1.5m
14	Laundry	1.8mx1.6m
15	Balcony -1	10.4mx2m
16	Balcony -2	3.9mx19m
17	Balcony -3	9.4mx2m

Level 9 , 10

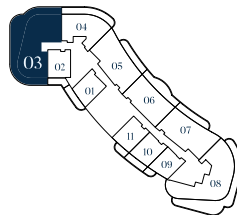

Suite Area	176.36 sq.m	to	176.88 sq.m
	1898.32 sq.ft	to	1903.92 sq.ft
Balcony Area	103.53 sq.m	to	189.32 sq.m
	1114.39 sq.ft	to	2037.82 sq.ft
Total Area	280.41 sq.m	to	365.68 sq.m
	3018.31 sq.ft	to	3936.15 sq.ft

3BHK - TYPE I

UNIT 1203

1	Kitchen	2.5mx2.6m
2	Living	6mx7.7m
3	PWD Room	2.4mx1.4m
4	Bedroom -1	4.5mx4.9m
5	Bath -1	2.3mx3m
6	Dress -1	2.3mx2.5m
7	Bedroom -2	5.1mx3.4m
8	Bath -2	1.8mx2.8m
9	Dress -2	1.4mx1.9m
10	Bedroom -3	5mx4m
11	Bath -3	2.7mx1.6m
12	Maid Room	2.4mx3.7m
13	Bath -4	1.3mx1.6m
14	Laundry	1.3mx1m
15	Balcony -1	6.4mx2.1m
16	Balcony -2	13.3mx2m
17	Balcony -3	4.4mx15.9m
18	Balcony -4	15.2mx8.1m
19	Balcony -5	8.7mx5.6m

Suite Area	180.47 sq.m
	1942.56 sq.ft
Balcony Area	244.67 sq.m
	2633.61 sq.ft
Total Area	425.14 sq.m
	4576.17 sq.ft

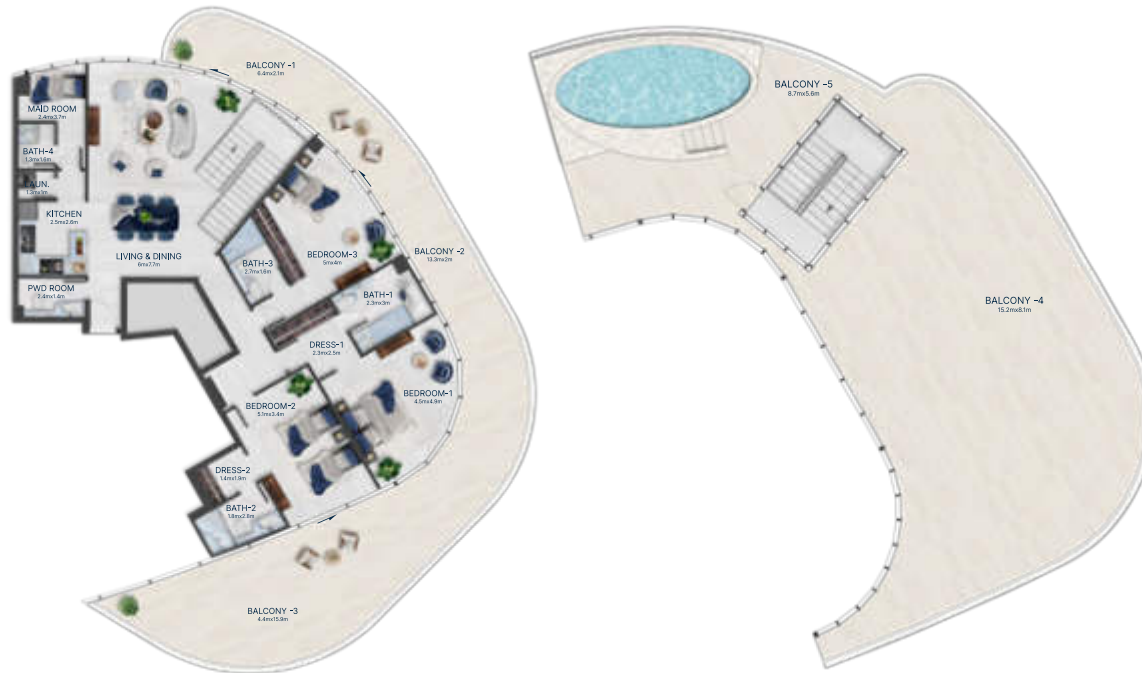

LOWER FLOOR PLAN

UPPER FLOOR PLAN

Level 12

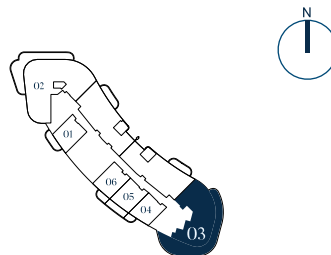

3BHK - TYPE J

UNIT 1008



1	Kitchen	2.9mx2.6m
2	Living	7.9mx7.7m
3	PWD Room	1.7mx1.4m
4	Bedroom -1	4.4mx6.5m
5	Bath -1	2.3mx3.8m
6	Dress -1	3.1mx3.8m
7	Bedroom -2	4.5mx5.6m
8	Bath -2	2mx2.7m
9	Dress -2	1.5mx1.7m
10	Bedroom -3	3.2mx5.7m
11	Bath -3	1.8mx2.9m
12	Dress -3	1.8mx2.6m
13	Store	2.3mx1.4m
14	Laundry	2.9mx1.4m
15	Balcony -1	7.9mx2m
16	Balcony -2	13.5mx2m
17	Balcony -3	4.1mx15.1m

Level 9 , 10

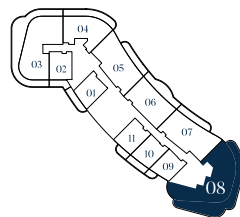

Key Plan



Suite Area	186.65 sq.m	
	2009.08 sq.ft	
Balcony Area	97.67 sq.m	to 133.49 sq.m
	1051.31 sq.ft	to 1436.87 sq.ft
Total Area	284.32 sq.m	to 320.14 sq.m
	3060.4 sq.ft	to 3445.96 sq.ft

4BHK - PENTHOUSE

UNIT 1102



Level 11

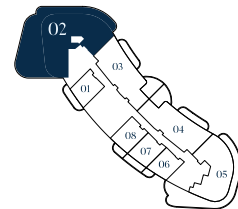

Key Plan

1	Kitchen	2.6mx3.7m
2	Living	10.4mx7.1m
3	PWD Room	1.4mx2.7m
4	Bedroom -1	6.3mx4.9m
5	Bath -1	3mx2.4m
6	Dress -1	3mx2.3m
7	Bedroom -2	5mx5.9m
8	Bath -2	2mx2.5m
9	Dress -2	2mx3.3m
10	Bedroom -3	4.1mx3.5m
11	Bath -3	2.5mx1.7m
12	Dress -3	2.5mx1.7m
13	Bedroom -4	4.6mx4.4m
14	Bath -4	1.6mx2.6m
15	Dress -4	1.6mx1.7m
16	Maid Room	2.5mx3.8m
17	Bath -5	1.4mx1.6m
18	Laundry	1.4mx1.2m
19	Balcony -1	8.8mx18.7m
20	Balcony -2	17.8mx2m
21	Balcony -3	7.9mx2m

Suite Area	253.66 sq.m
	2730.37 sq.ft
Balcony Area	185.57 sq.m
	1997.46 sq.ft
Total Area	439.23 sq.m
	4727.83 sq.ft

Disclaimer: All dimensions, materials and drawings are approximate. Information is subject to change without notice, at the developer's absolute discretion. The actual area may vary from the stated area. Drawings are not to scale. All images used are for illustrative purposes only and do not represent the actual size, features, specifications, fittings and furnishings. The developer reserves the right to make revisions/alterations, at the absolute discretion without any liability whatsoever.

4BHK - PENTHOUSE DUPLEX

UNIT 1202

LOWER FLOOR PLAN



UPPER FLOOR PLAN



Level 12

Key Plan

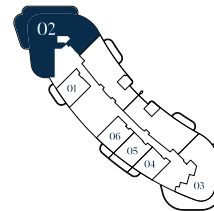

Suite Area	266.74 sq.m
	2871.17 sq.ft
Balcony Area	244.41 sq.m
	2630.81 sq.ft
Total Area	511.15 sq.m
	5501.97 sq.ft

1	Kitchen	2.6mx3.7m
2	Living	8.6mx7.7m
3	PWD Room	1.4mx2.1m
4	Bedroom -1	6.3mx4.9m
5	Bath -1	3mx2.4m
6	Dress -1	3mx2.3m
7	Bedroom -2	4.8mx5.9m
8	Bath -2	2.2mx2.8m
9	Dress -2	2.2mx3m
10	Bedroom -3	4.1mx3.5m
11	Bath -3	2.6mx1.7m
12	Dress -3	2.6mx1.7m
13	Bedroom -4	4.6mx4.4m
14	Bath -4	1.7mx2.6m
15	Dress -4	1.7mx1.7m
16	Maid Room	2.5mx3.8m
17	Bath -5	1.4mx1.6m
18	Laundry	1.4mx1.2m
19	Balcony -1	2.7mx10.2m
20	Balcony -2	15.9mx2m
21	Balcony -3	12.1mx6.8m
22	Balcony -4	10.1mx5.6m
23	Balcony -5	3.6mx17.9m

4BHK - PENTHOUSE TRIPLEX - 1

UNIT 1103

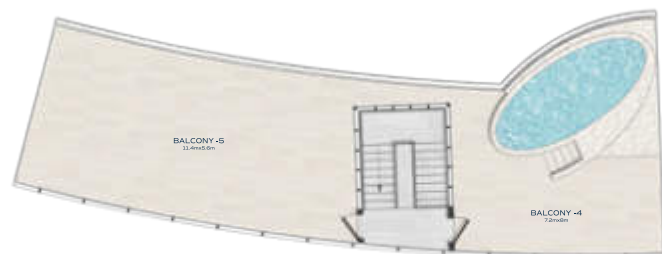

ROOF FLOOR PLAN



UPPER FLOOR PLAN



LOWER FLOOR PLAN

Level 11

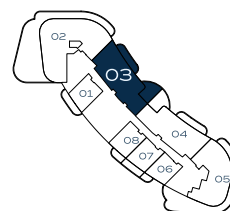

Key Plan

Suite Area	353.78 sq.m
	3808.06 sq.ft
Balcony Area	190.17 sq.m
	2046.97 sq.ft
Total Area	543.95 sq.m
	5855.03 sq.ft

1	Kitchen	3.4mx3.4m
2	Living	10.3mx8.4m
3	Family Living	6.4mx4.8m
4	PWD Room	1.4mx2.3m
5	Wash Room	1.9mx1.8m
6	Bedroom -1	6.9mx5.1m
7	Bath -1	2.1mx3.2m
8	Dress -1	2.5mx2.7m
9	Bedroom -2	6.5mx5.1m
10	Bath -2	2.1mx3.2m
11	Dress -2	2.5mx3.2m
12	Bedroom -3	3.8mx5.1m
13	Bath -3	2.6mx1.8m
14	Dress -3	1.6mx1.8m
15	Bedroom -4	3.8mx3.8m
16	Bath -4	1.8mx2.6m
17	Dress -4	1.8mx2.6m
18	Maid Room	2.6x2.1m
19	Bath -5	2mx1.7m
20	Dress -5	2.1mx1.2m
21	Store	2.5mx1.4m
22	Laundry	1mx1.4m
23	Balcony -1	9.9mx2m
24	Balcony -2	5.5mx6.3m
25	Balcony -3	7.9mx2m
26	Balcony -4	7.2mx8m
27	Balcony -5	11.4mx5.6m

4BHK - PENTHOUSE TRIPLEX - 2 UNIT 1104

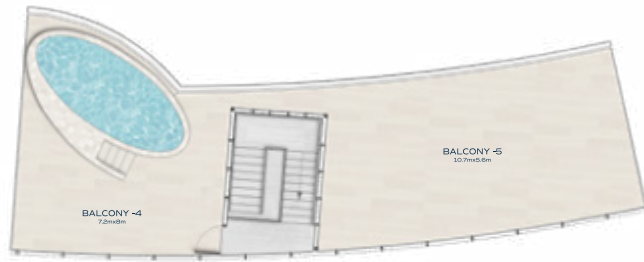

ROOF FLOOR PLAN



UPPER FLOOR PLAN



LOWER FLOOR PLAN

Level 11

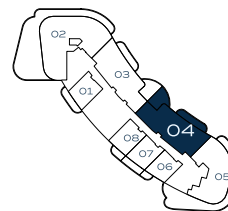

Key Plan

Suite Area	347.37 sq.m
	3739.06 sq.ft
Balcony Area	173.32 sq.m
	1865.6 sq.ft
Total Area	520.69 sq.m
	5604.66 sq.ft

1	Kitchen	3.4mx3.4m
2	Living	10.3mx8.4m
3	Family Living	6.4mx4.8m
4	PWD Room	1.4mx2.3m
5	Wash Room	1.9mx1.8m
6	Bedroom -1	6.9mx5.1m
7	Bath -1	2.1mx3.2m
8	Dress -1	2.5mx2.7m
9	Bedroom -2	6.5mx5.1m
10	Bath -2	2.1mx3.2m
11	Dress -2	2.5mx3.2m
12	Bedroom -3	3.8mx5.1m
13	Bath -3	2.6mx1.8m
14	Dress -3	2.6mx1.8m
15	Bedroom -4	3.8mx3.8m
16	Bath -4	1.8mx2.6m
17	Dress -4	1.9mx2.6m
18	Maid Room	2.6x2.1m
19	Bath -5	2mx1.7m
20	Dress -5	2.1mx1.4m
21	Store	2.5mx2m
22	Laundry	1mx1.4m
23	Balcony -1	10.3mx2m
24	Balcony -2	5.5mx6.3m
25	Balcony -3	7.5mx2m
26	Balcony -4	7.2mx8m
27	Balcony -5	10.7mx5.6m

RESTAURANT

1	Restaurant	32.5mx20.4m
2	Terrace	21.1mx14.7m

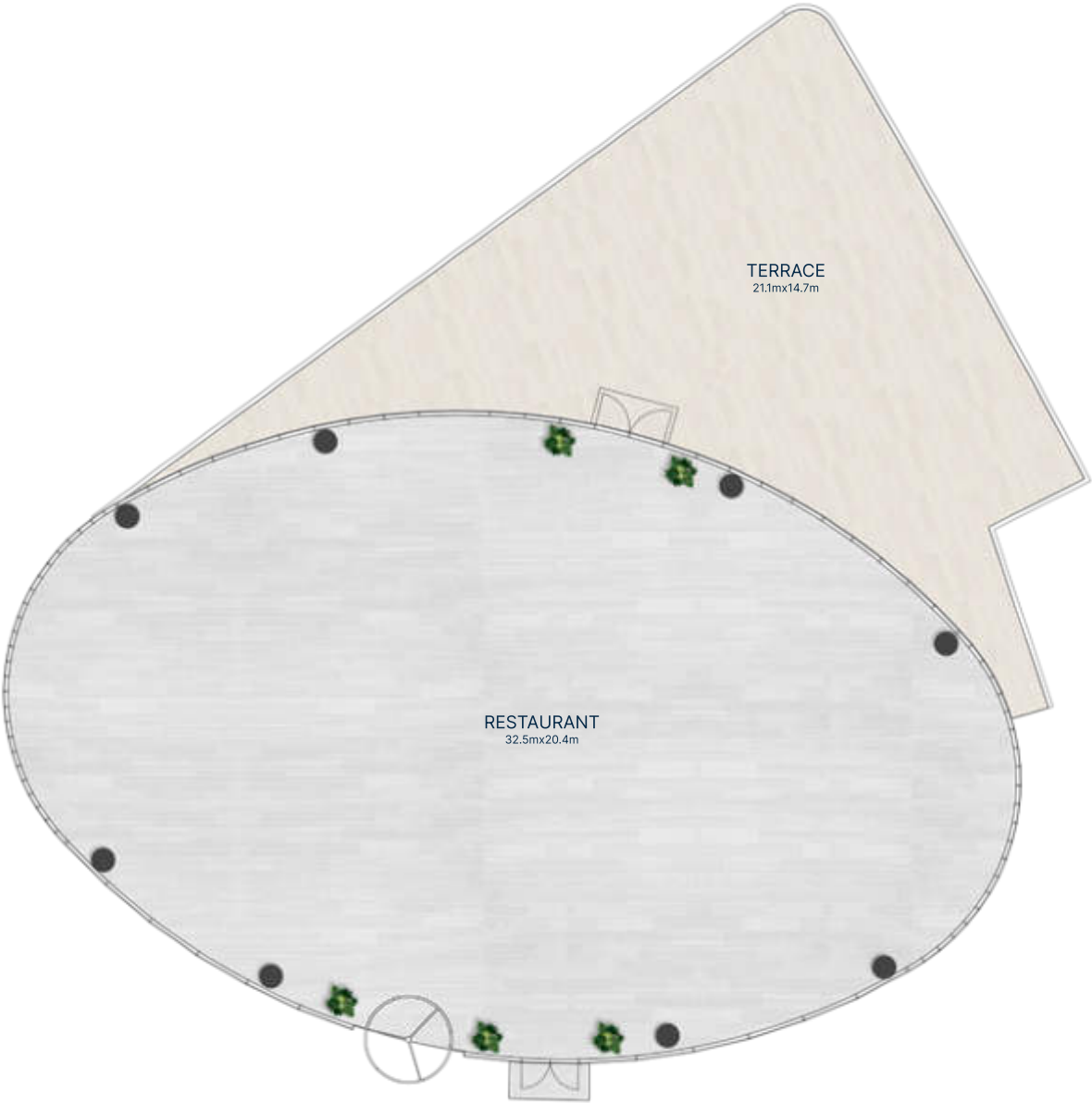

Suite Area	524.46 sq.m
	5645.24 sq.ft
Balcony Area	237.8 sq.m
	2559.66 sq.ft
Total Area	762.26 sq.m
	8204.9 sq.ft





housebook Real Estate Company
since 2012 in the UAE

+971 (4) 412-5007

Partnership managers



Alevtina Kapustina



Svetlana Guseva

Office

Housebook Real Estate LCC

Marina Plaza, office 2502-01, Dubai, UAE

Company license: 1128098

ae.housebook.deals

partner@housebook.ae

