

Rosehill

DUBAI HILLS ESTATE

EMAAR

Rosehill

DUBAI HILLS ESTATE

BLOCK A

1 BEDROOM TYPE 1A

UNITS

207, 307, 407, 507, 607, 707, 807, 908, 1007, 1107, 1207, 1307, 1407,
1507, 1607, 1707, 1807, 1907, 2007, 2107,

SUITE AREA	705.68 SQ.FT.	65.56 SQ.M.
BALCONY AREA	61.03 SQ.FT.	5.67 SQ.M.
TOTAL AREA	766.71 SQ.FT.	71.23 SQ.M.

KEY SECTION

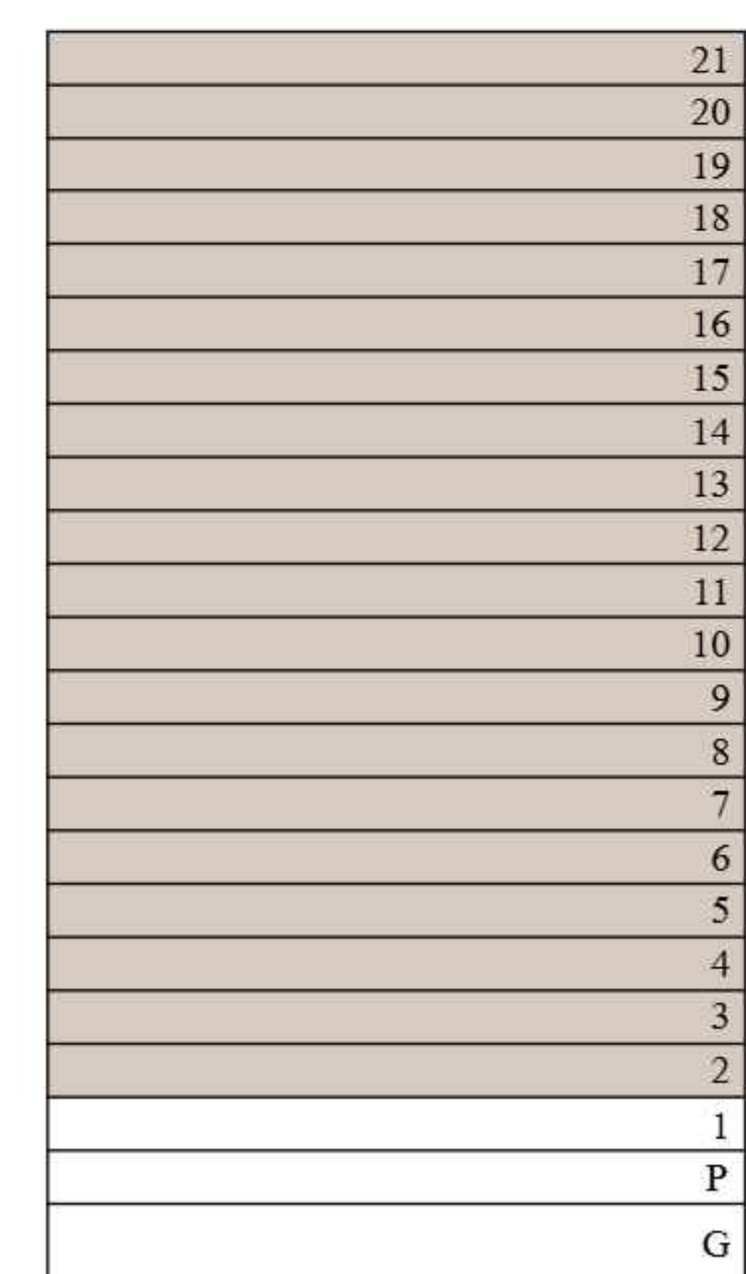

KEY PLAN

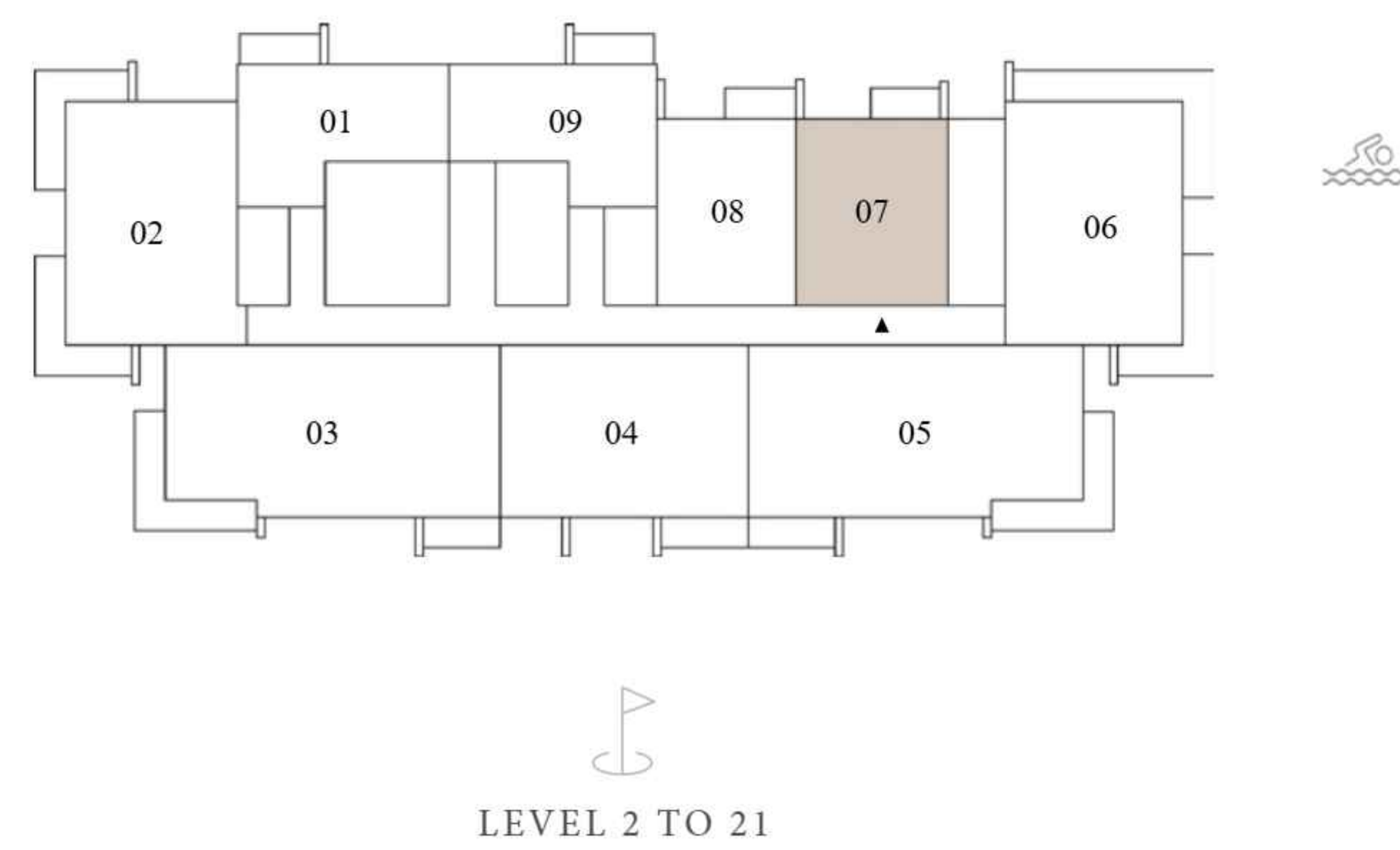

LEVEL 2 TO 21



FLOOR PLAN 1. All dimensions are in imperial and metric, and measured from finish to finish excluding construction tolerances. 2. All materials, dimensions, and drawings are approximate only. 3. Information is subject to change without notice, at developer's absolute discretion. 4. Actual area may vary from the stated area. 5. Drawings not to scale. 6. All images used are for illustrative purposes only and do not represent the actual size, features, specifications, fittings, and furnishings. 7. The developer reserves the right to make revisions / alterations, at it's absolute discretion, without any liability whatsoever.

EMAAR

Rosehill

DUBAI HILLS ESTATE

BLOCK A

1 BEDROOM TYPE 1A

UNITS

208, 308, 408, 508, 608, 708, 808, 908, 1008, 1108, 1208, 1308, 1408,
1508, 1608, 1708, 1808, 1908, 2008, 2108,

SUITE AREA	697.61 SQ.FT.	64.81 SQ.M.
BALCONY AREA	62.00 SQ.FT.	5.76 SQ.M.
TOTAL AREA	759.61 SQ.FT.	70.57 SQ.M.

KEY SECTION

KEY PLAN

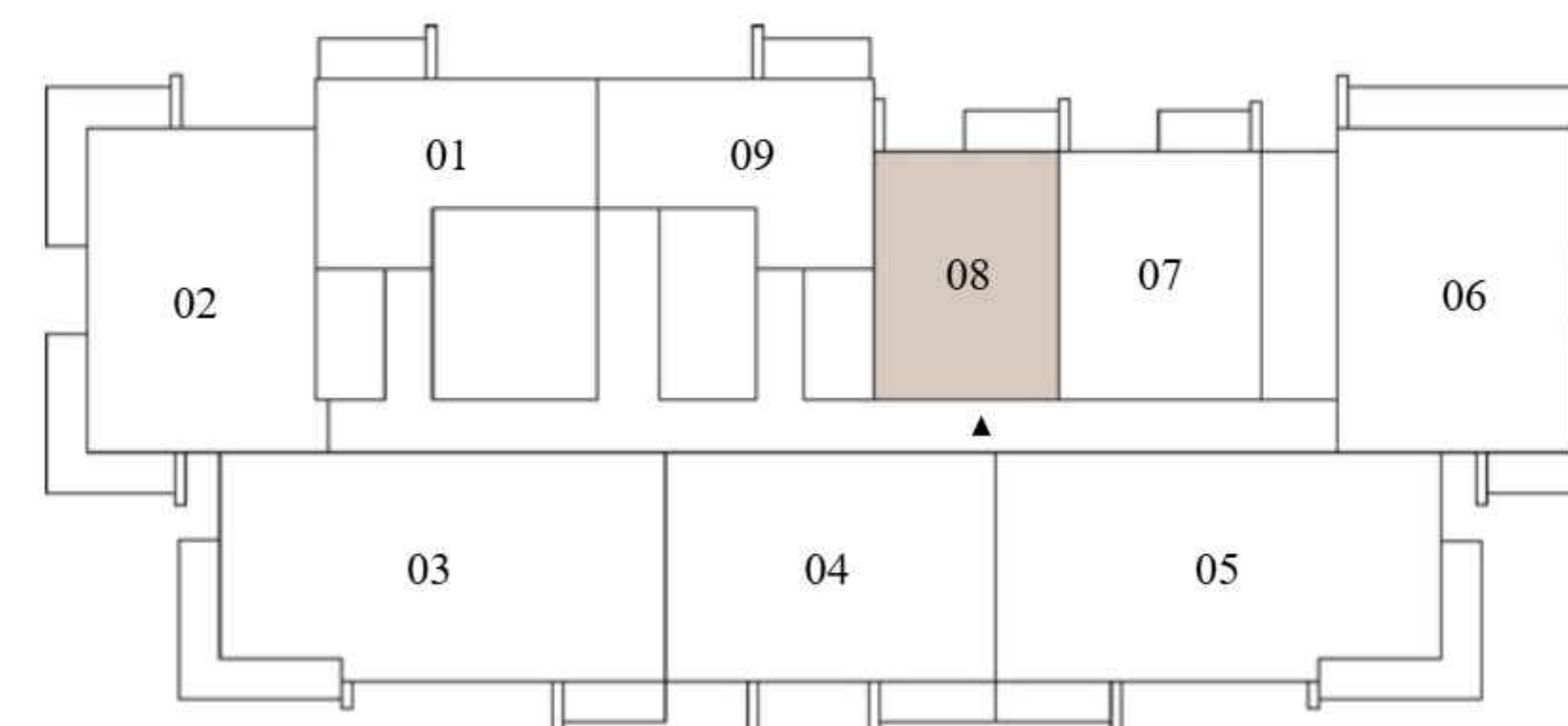
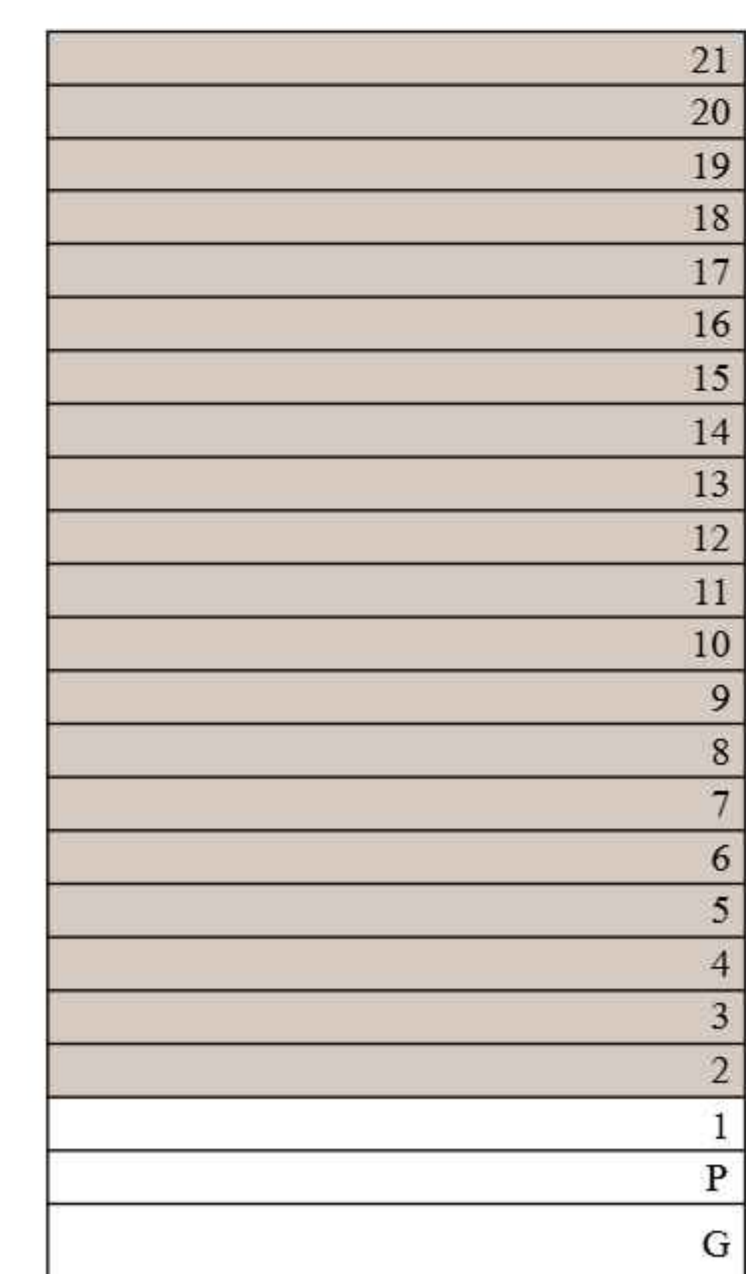

LEVEL 2 TO 21

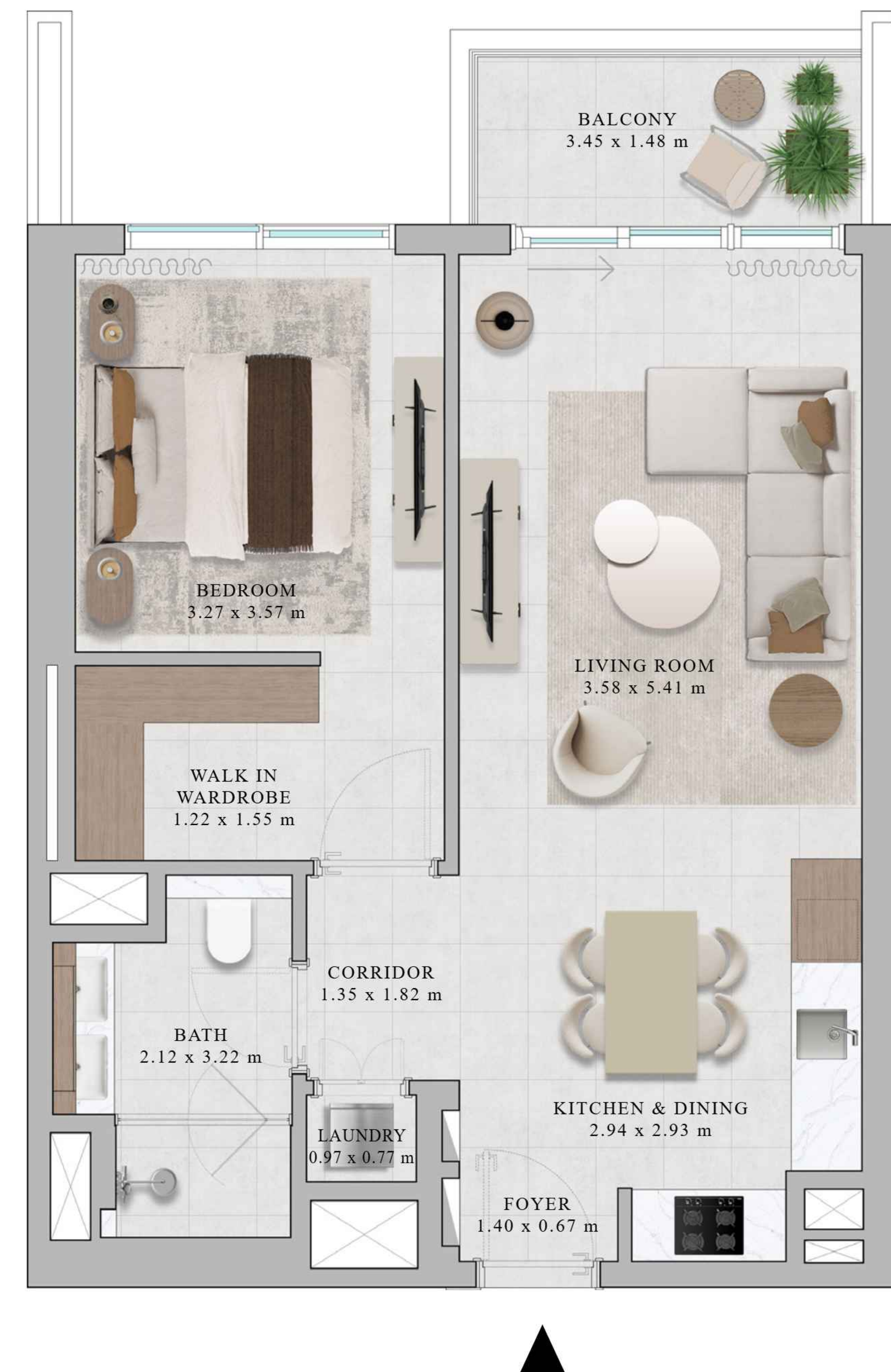

FLOOR PLAN 1. All dimensions are in imperial and metric, and measured from finish to finish excluding construction tolerances. 2. All materials, dimensions, and drawings are approximate only. 3. Information is subject to change without notice, at developer's absolute discretion. 4. Actual area may vary from the stated area. 5. Drawings not to scale. 6. All images used are for illustrative purposes only and do not represent the actual size, features, specifications, fittings, and furnishings. 7. The developer reserves the right to make revisions / alterations, at it's absolute discretion, without any liability whatsoever.

EMAAR

Rosehill

DUBAI HILLS ESTATE

BLOCK A

1 BEDROOM TYPE 1B

UNITS

107

SUITE AREA	704.28 SQ.FT.	65.43 SQ.M.
BALCONY AREA	118.51 SQ.FT.	11.01 SQ.M.
TOTAL AREA	822.79 SQ.FT.	76.44 SQ.M.

KEY SECTION

KEY PLAN

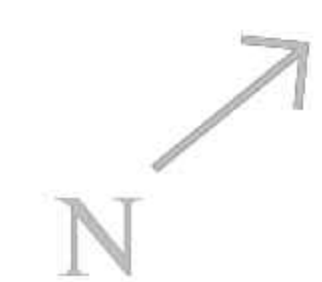

21
20
19
18
17
16
15
14
13
12
11
10
9
8
7
6
5
4
3
2
1
P
G

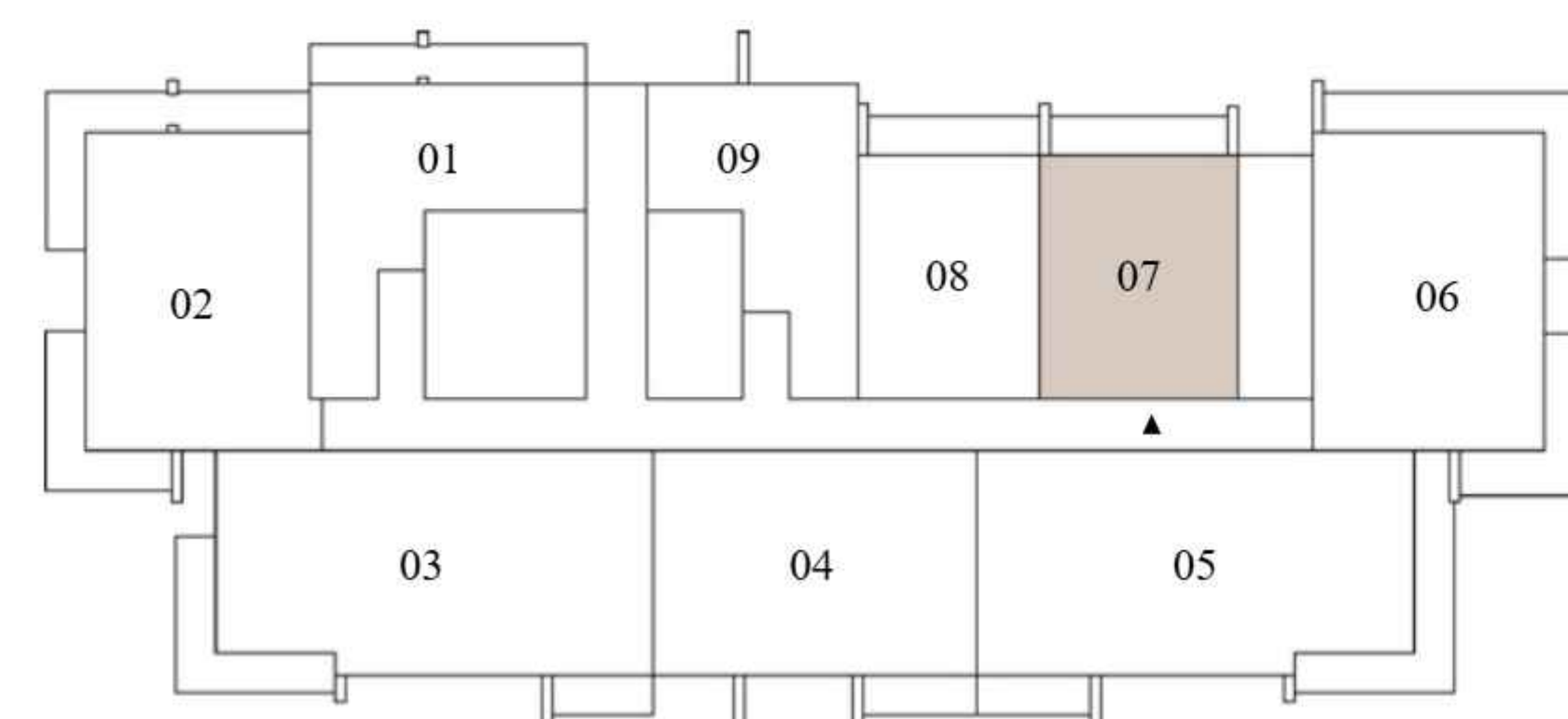

LEVEL 1



FLOOR PLAN 1. All dimensions are in imperial and metric, and measured from finish to finish excluding construction tolerances. 2. All materials, dimensions, and drawings are approximate only. 3. Information is subject to change without notice, at developer's absolute discretion. 4. Actual area may vary from the stated area. 5. Drawings not to scale. 6. All images used are for illustrative purposes only and do not represent the actual size, features, specifications, fittings, and furnishings. 7. The developer reserves the right to make revisions / alterations, at it's absolute discretion, without any liability whatsoever.

EMAAR

Rosehill

DUBAI HILLS ESTATE

BLOCK A

1 BEDROOM TYPE 1B

UNITS

108

SUITE AREA	696.10 SQ.FT.	64.67 SQ.M.
BALCONY AREA	113.56 SQ.FT.	10.55 SQ.M.
TOTAL AREA	809.66 SQ.FT.	75.22 SQ.M.

KEY SECTION

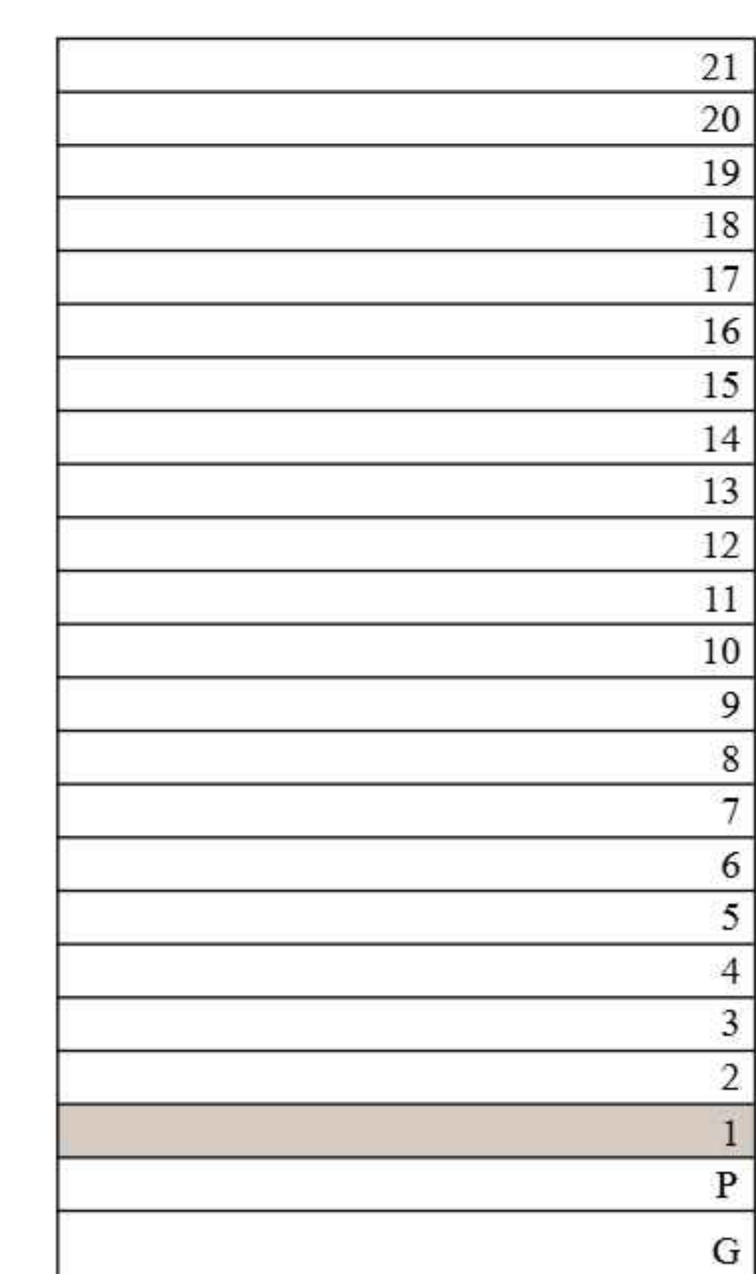

KEY PLAN

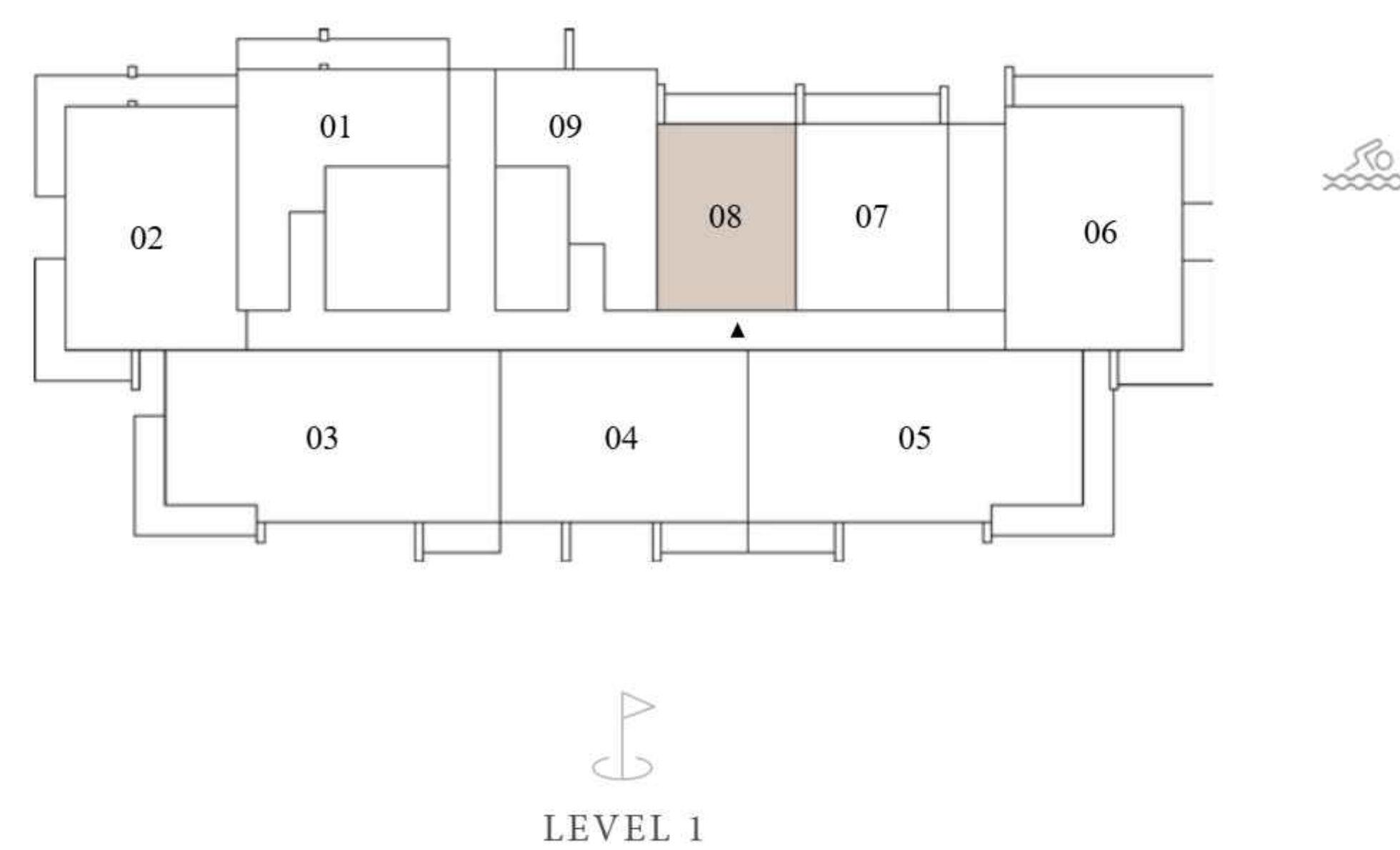

FLOOR PLAN 1. All dimensions are in imperial and metric, and measured from finish to finish excluding construction tolerances. 2. All materials, dimensions, and drawings are approximate only. 3. Information is subject to change without notice, at developer's absolute discretion. 4. Actual area may vary from the stated area. 5. Drawings not to scale. 6. All images used are for illustrative purposes only and do not represent the actual size, features, specifications, fittings, and furnishings. 7. The developer reserves the right to make revisions / alterations, at it's absolute discretion, without any liability whatsoever.

Rosehill

DUBAI HILLS ESTATE

BLOCK A

1 BEDROOM TYPE 2A

UNITS

201, 301, 401, 501, 601, 701, 801, 901, 1001, 1101, 1201, 1301, 1401,
1501, 1601, 1701, 1801, 1901, 2001, 2101

SUITE AREA	625.38 SQ.FT.	58.10 SQ.M.
BALCONY AREA	70.50 SQ.FT.	6.55 SQ.M.
TOTAL AREA	695.88 SQ.FT.	64.65 SQ.M.



KEY SECTION

KEY PLAN

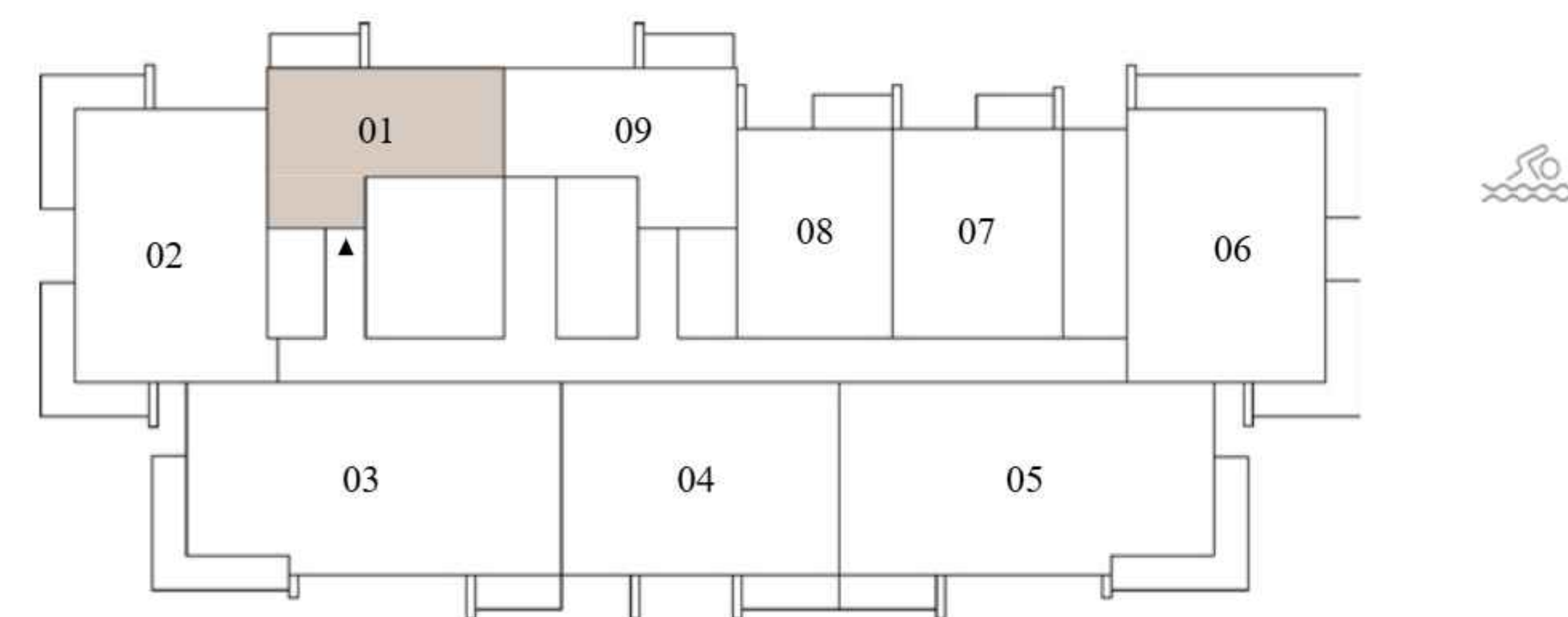
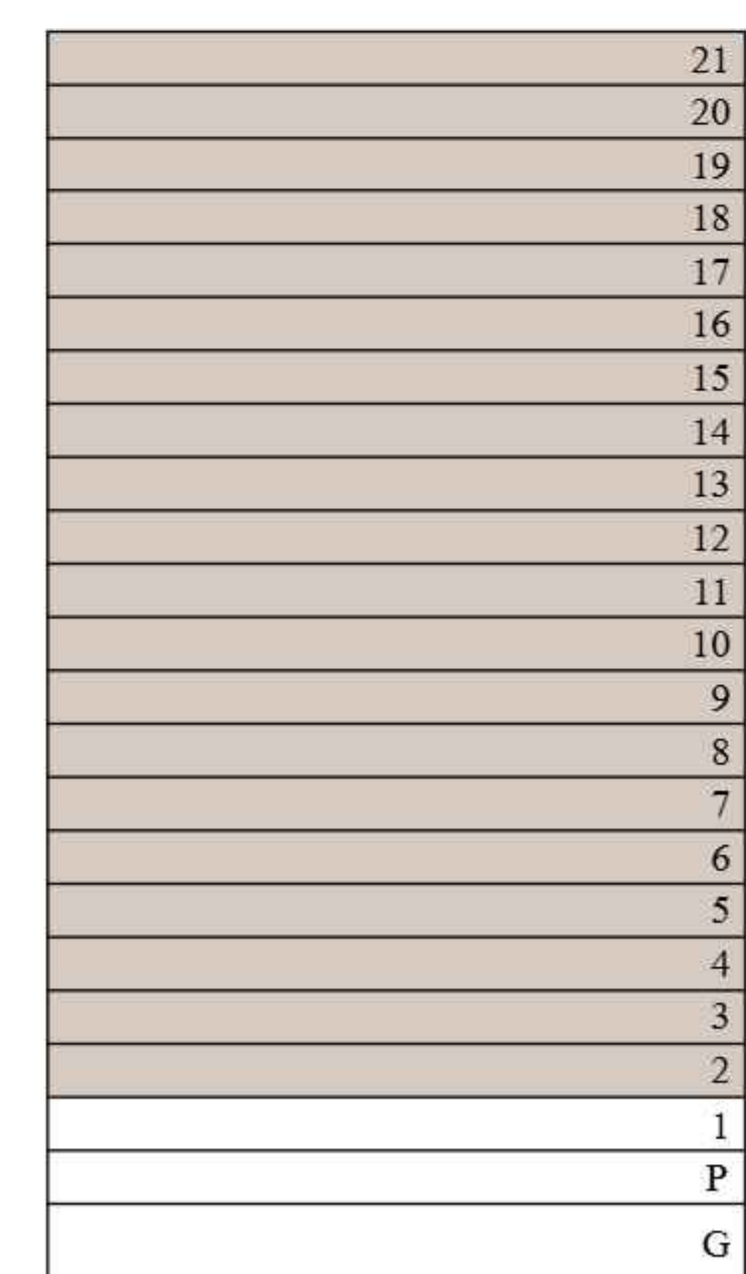
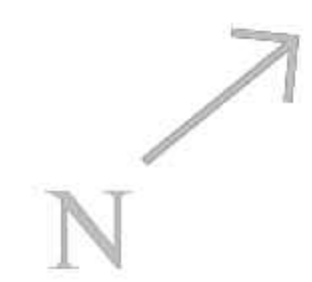

LEVEL 2 TO 21

FLOOR PLAN 1. All dimensions are in imperial and metric, and measured from finish to finish excluding construction tolerances. 2. All materials, dimensions, and drawings are approximate only. 3. Information is subject to change without notice, at developer's absolute discretion. 4. Actual area may vary from the stated area. 5. Drawings not to scale. 6. All images used are for illustrative purposes only and do not represent the actual size, features, specifications, fittings, and furnishings. 7. The developer reserves the right to make revisions / alterations, at it's absolute discretion, without any liability whatsoever.

EMAAR

Rosehill

DUBAI HILLS ESTATE

BLOCK A

1 BEDROOM TYPE 2B

UNITS

209, 309, 409, 509, 609, 709, 809, 909, 1009, 1109, 1209, 1309, 1409,
1509, 1609, 1709, 1809, 1909, 2009, 2109

SUITE AREA	623.34 SQ.FT.	57.91 SQ.M.
BALCONY AREA	70.50 SQ.FT.	6.55 SQ.M.
TOTAL AREA	693.84 SQ.FT.	64.46 SQ.M.



KEY SECTION

KEY PLAN

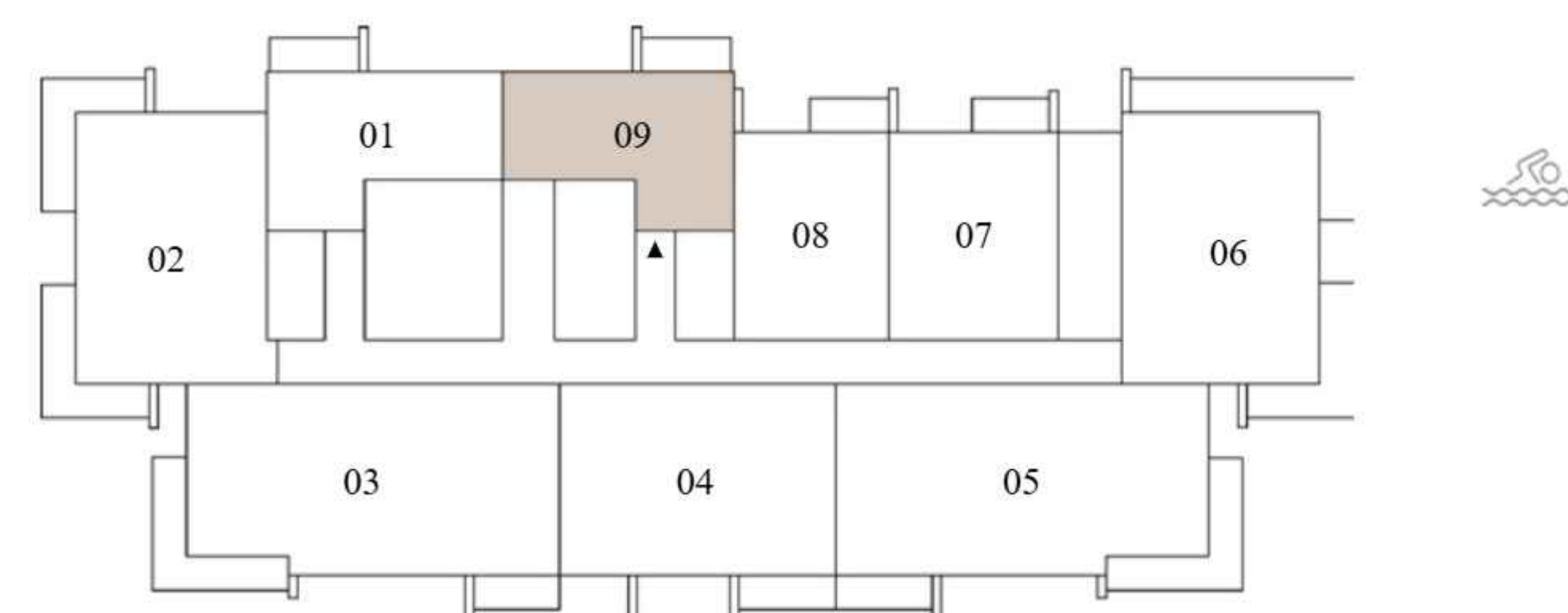
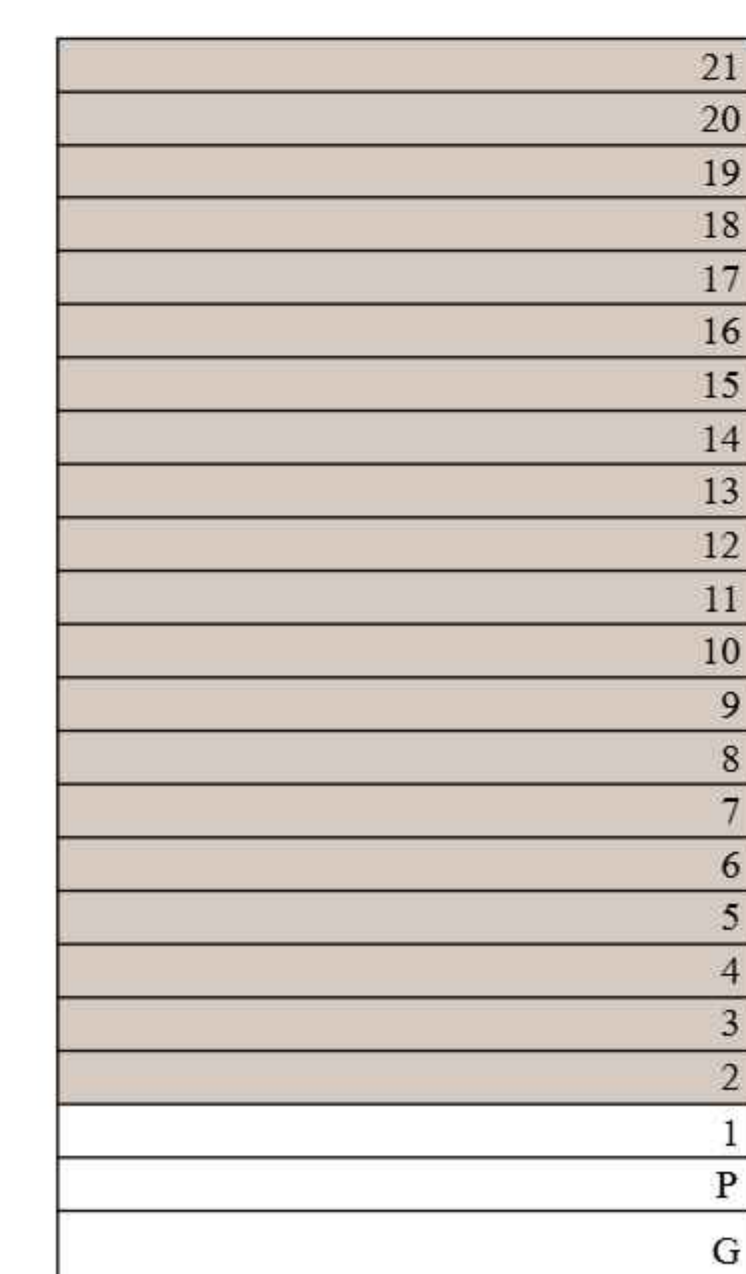

LEVEL 2 TO 21

FLOOR PLAN 1. All dimensions are in imperial and metric, and measured from finish to finish excluding construction tolerances. 2. All materials, dimensions, and drawings are approximate only. 3. Information is subject to change without notice, at developer's absolute discretion. 4. Actual area may vary from the stated area. 5. Drawings not to scale. 6. All images used are for illustrative purposes only and do not represent the actual size, features, specifications, fittings, and furnishings. 7. The developer reserves the right to make revisions / alterations, at it's absolute discretion, without any liability whatsoever.

EMAAR

Rosehill

DUBAI HILLS ESTATE

BLOCK A

1 BEDROOM TYPE 2C

UNITS

101

SUITE AREA	624.84 SQ.FT.	58.05 SQ.M.
BALCONY AREA	185.68 SQ.FT.	17.25 SQ.M.
TOTAL AREA	810.52 SQ.FT.	75.30 SQ.M.



KEY SECTION

KEY PLAN



21
20
19
18
17
16
15
14
13
12
11
10
9
8
7
6
5
4
3
2
1
P
G

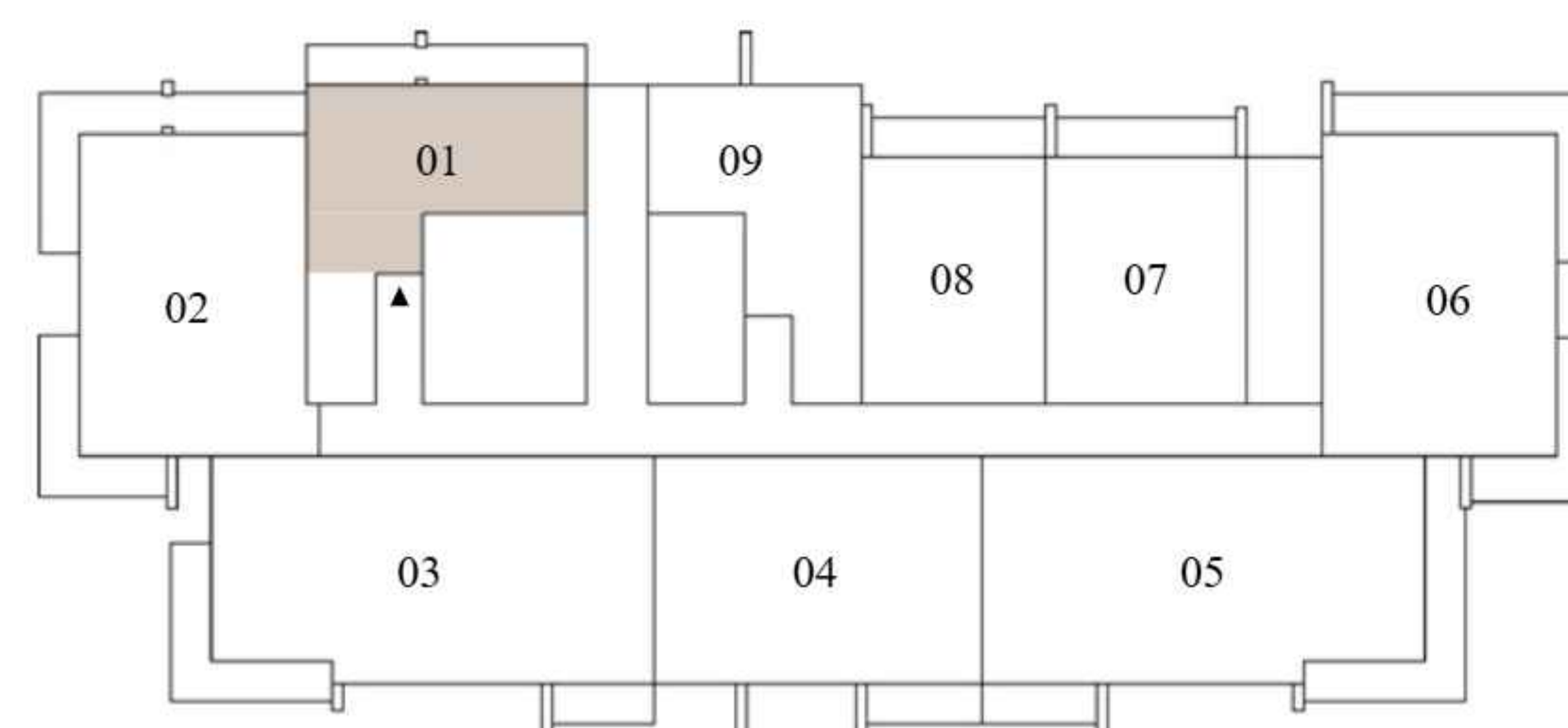

LEVEL 1

FLOOR PLAN 1. All dimensions are in imperial and metric, and measured from finish to finish excluding construction tolerances. 2. All materials, dimensions, and drawings are approximate only. 3. Information is subject to change without notice, at developer's absolute discretion. 4. Actual area may vary from the stated area. 5. Drawings not to scale. 6. All images used are for illustrative purposes only and do not represent the actual size, features, specifications, fittings, and furnishings. 7. The developer reserves the right to make revisions / alterations, at it's absolute discretion, without any liability whatsoever.

EMAAR

Rosehill

DUBAI HILLS ESTATE

BLOCK A

2 BEDROOM TYPE 1A

UNITS

P02, 104, 204, 304, 404, 504, 604, 704, 804, 904, 1004, 1104, 1204,
1304, 1404, 1504, 1604, 1704, 1804, 1904, 2004, 2104

SUITE AREA	1109.44 - 1110.51 SQ.FT.	103.07 - 103.17 SQ.M.
BALCONY AREA	76.32 - 78.04 SQ.FT.	7.09 - 7.25 SQ.M.
TOTAL AREA	1186.83 - 1187.80 SQ.FT.	110.26 - 110.35 SQ.M.



KEY SECTION

KEY PLAN

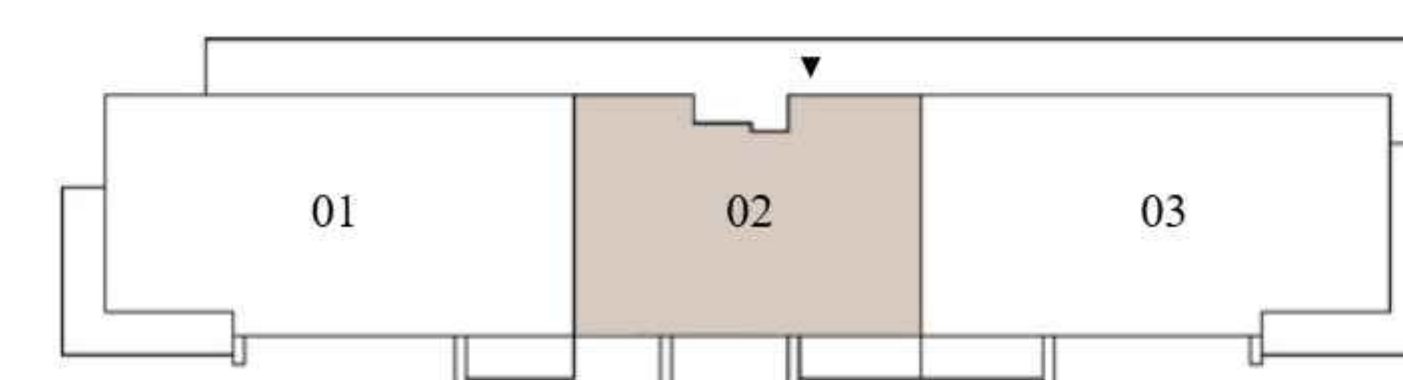
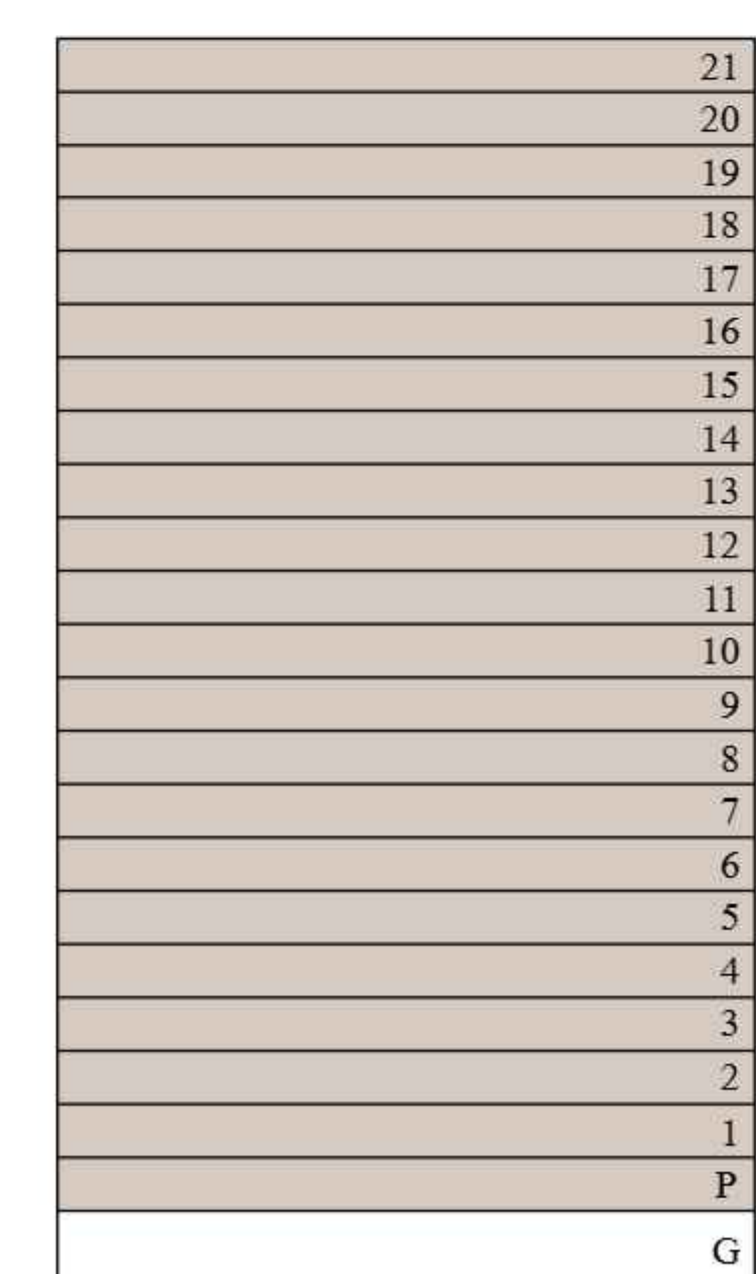

PODIUM

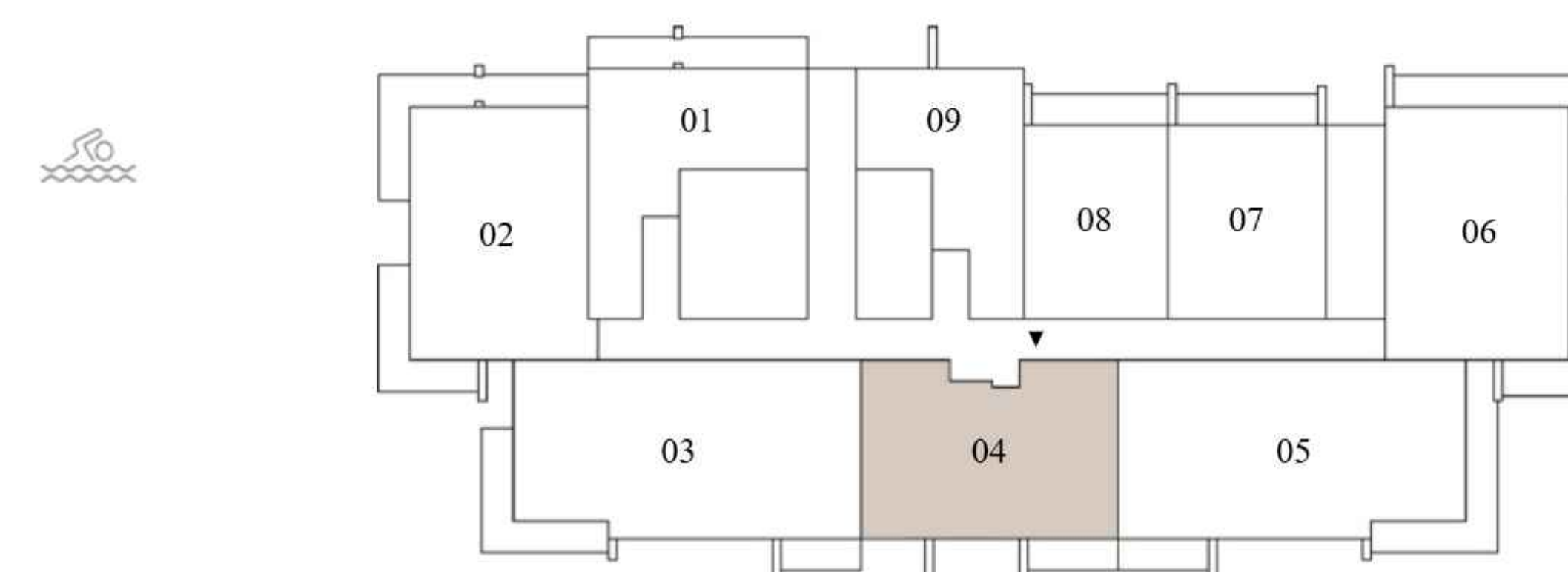

LEVEL 1

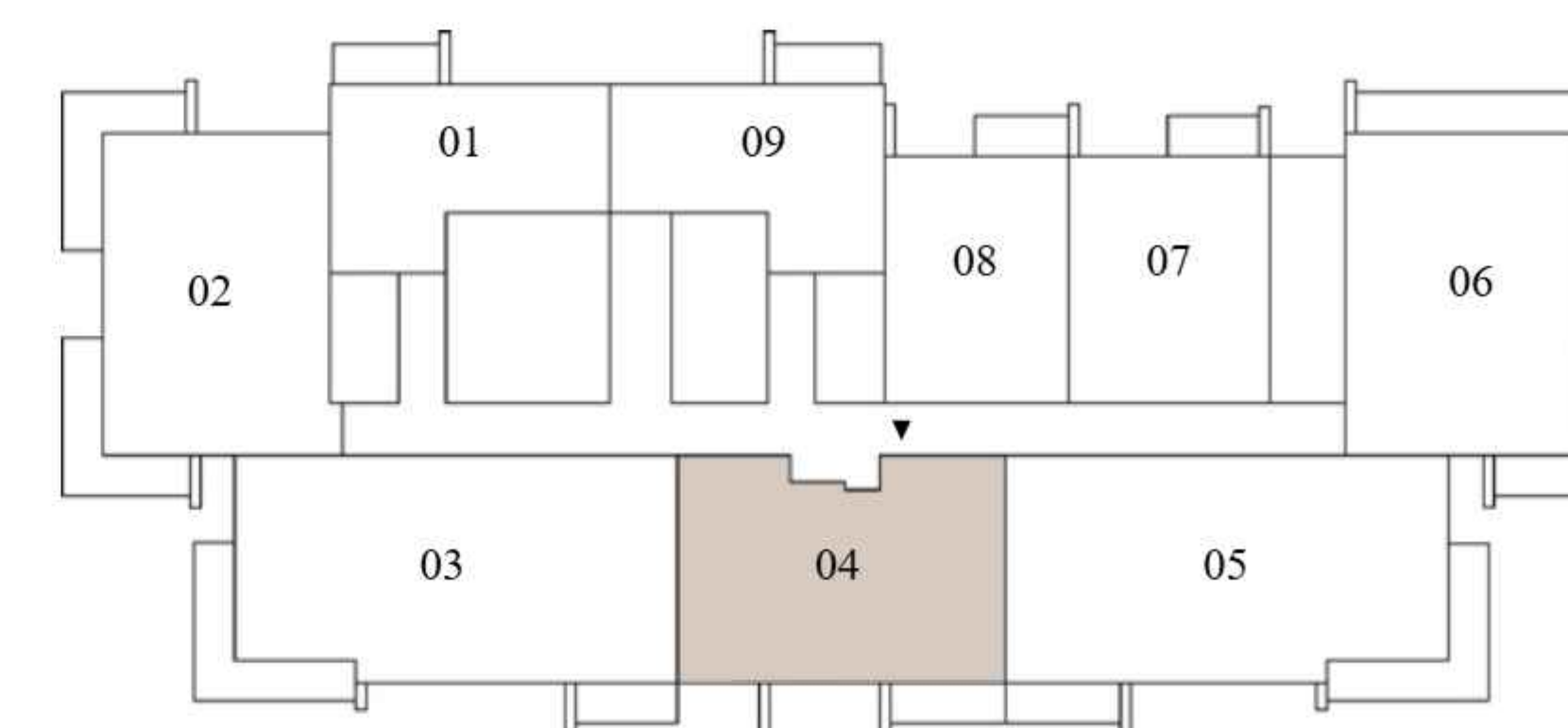

LEVEL 2 TO 21

FLOOR PLAN 1. All dimensions are in imperial and metric, and measured from finish to finish excluding construction tolerances. 2. All materials, dimensions, and drawings are approximate only. 3. Information is subject to change without notice, at developer's absolute discretion. 4. Actual area may vary from the stated area. 5. Drawings not to scale. 6. All images used are for illustrative purposes only and do not represent the actual size, features, specifications, fittings, and furnishings. 7. The developer reserves the right to make revisions / alterations, at it's absolute discretion, without any liability whatsoever.

Rosehill

DUBAI HILLS ESTATE

BLOCK A

2 BEDROOM TYPE 1B

UNITS
GO2

SUITE AREA	1108.90 SQ.FT.	103.02 SQ.M.
BALCONY AREA	282.77 SQ.FT.	26.27 SQ.M.
TOTAL AREA	1391.67 SQ.FT.	129.29 SQ.M.



KEY SECTION

KEY PLAN

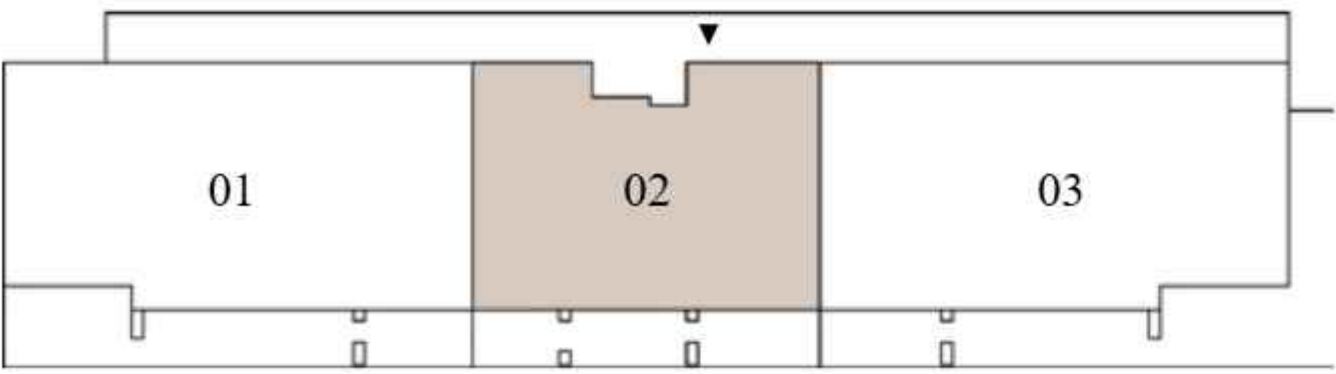
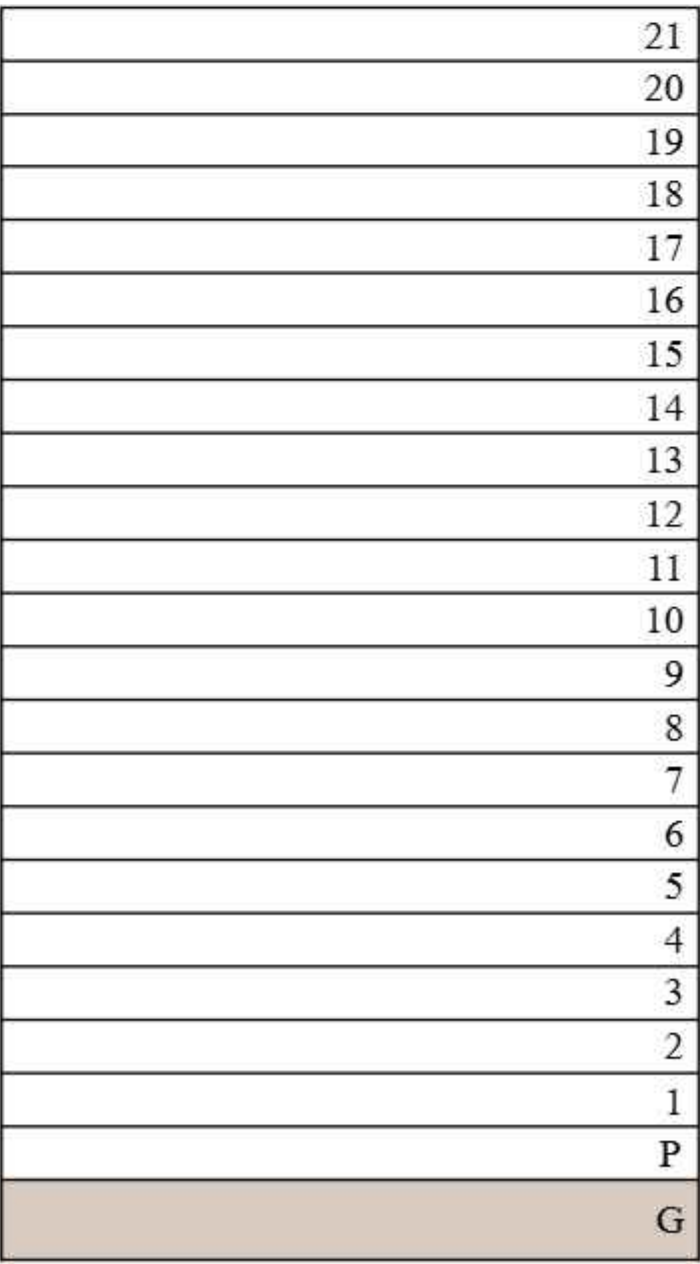
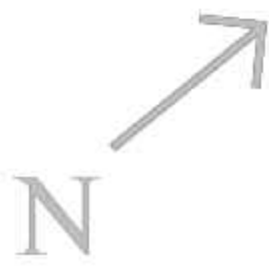

FLOOR PLAN 1. All dimensions are in imperial and metric, and measured from finish to finish excluding construction tolerances. 2. All materials, dimensions, and drawings are approximate only. 3. Information is subject to change without notice, at developer's absolute discretion. 4. Actual area may vary from the stated area. 5. Drawings not to scale. 6. All images used are for illustrative purposes only and do not represent the actual size, features, specifications, fittings, and furnishings. 7. The developer reserves the right to make revisions / alterations, at it's absolute discretion, without any liability whatsoever.

Rosehill

DUBAI HILLS ESTATE

BLOCK A

2 BEDROOM TYPE 2A

UNITS

202, 302, 402, 502, 602, 702, 802, 902, 1002, 1102, 1202, 1302, 1402,
1502, 1602, 1702, 1802, 1902, 2002, 2102

SUITE AREA	1102.98 SQ.FT.	102.47 SQ.M.
BALCONY AREA	316.24 SQ.FT.	29.38 SQ.M.
TOTAL AREA	1419.22 SQ.FT.	131.85 SQ.M.



KEY SECTION

KEY PLAN

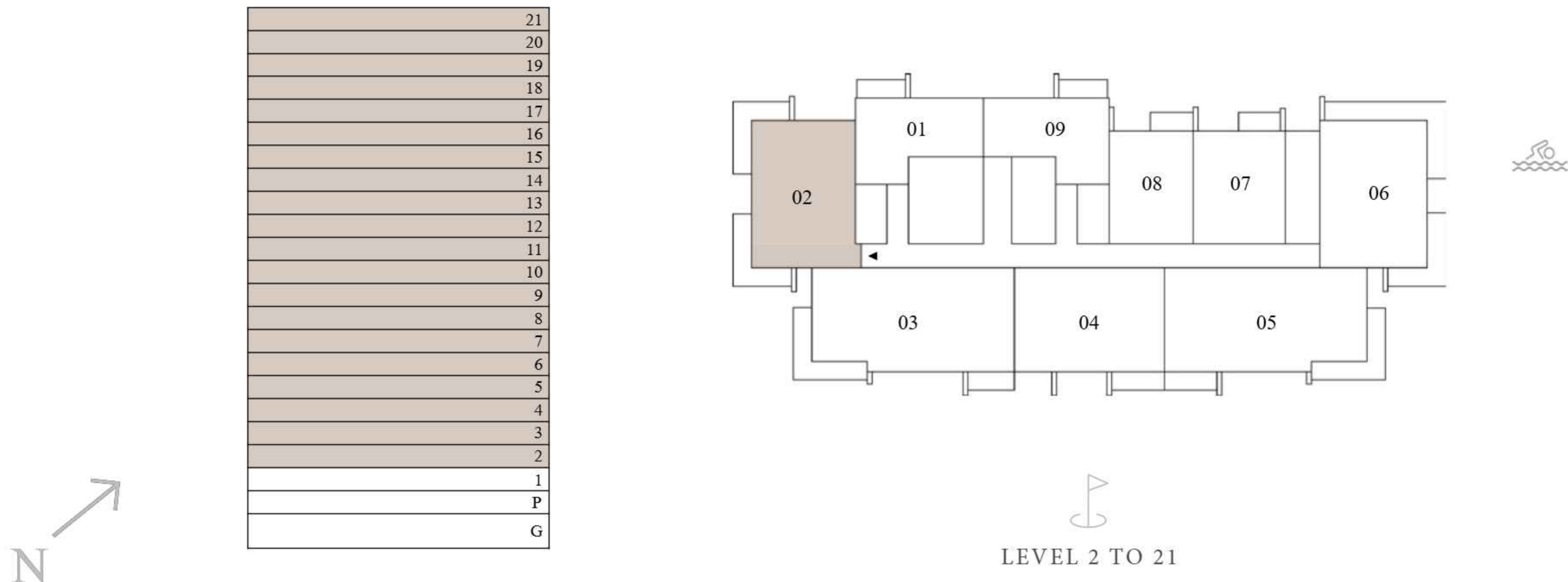

FLOOR PLAN 1. All dimensions are in imperial and metric, and measured from finish to finish excluding construction tolerances. 2. All materials, dimensions, and drawings are approximate only. 3. Information is subject to change without notice, at developer’s absolute discretion. 4. Actual area may vary from the stated area. 5. Drawings not to scale. 6. All images used are for illustrative purposes only and do not represent the actual size, features, specifications, fittings, and furnishings. 7. The developer reserves the right to make revisions / alterations, at it’s absolute discretion, without any liability whatsoever.

Rosehill

DUBAI HILLS ESTATE

BLOCK A

2 BEDROOM TYPE 2B

UNITS

206, 306, 406, 506, 606, 706, 806, 906, 1006, 1106, 1206, 1306, 1406,
1506, 1606, 1706, 1806, 1906, 2006, 2106

SUITE AREA	1103.41 SQ.FT.	102.51 SQ.M.
BALCONY AREA	416.78 SQ.FT.	38.72 SQ.M.
TOTAL AREA	1520.19 SQ.FT.	141.23 SQ.M.



KEY SECTION

KEY PLAN

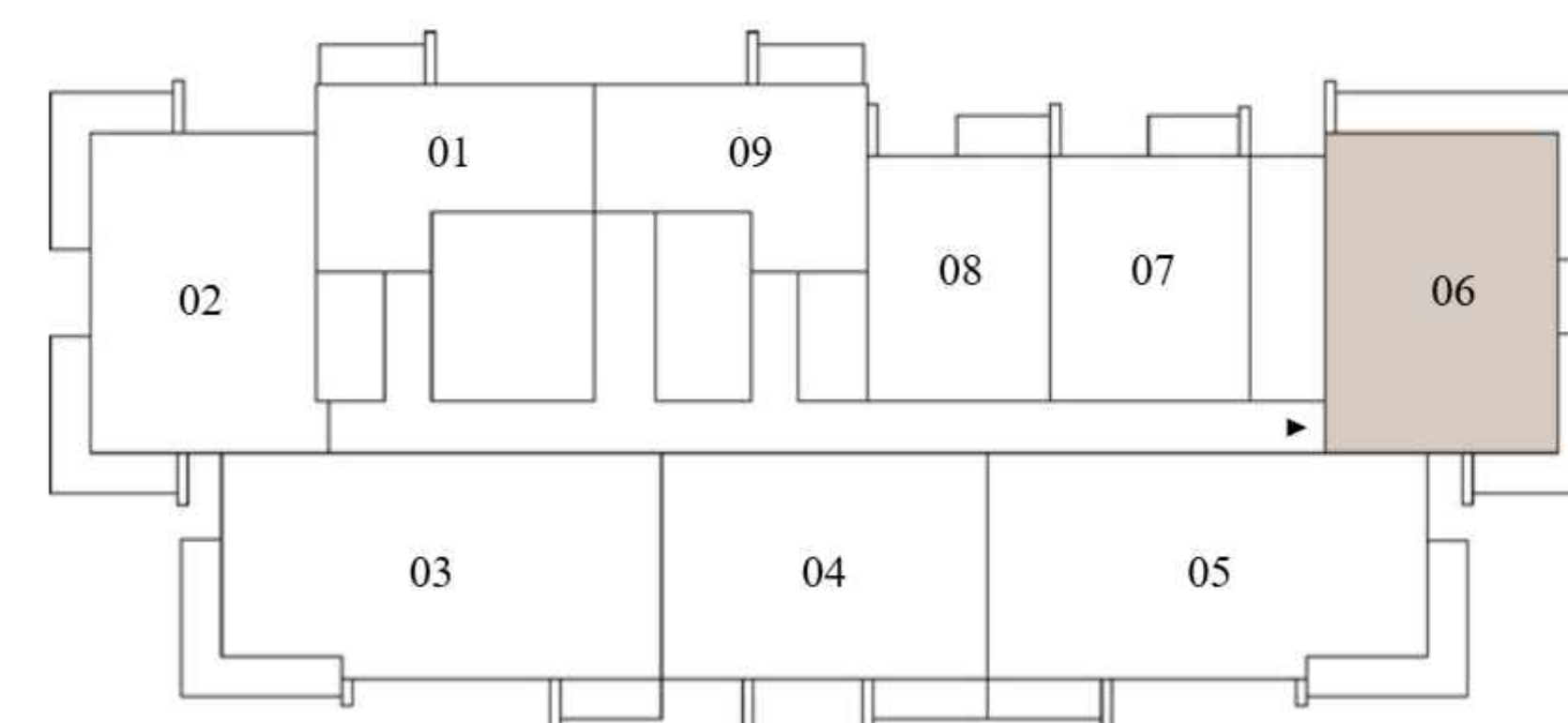
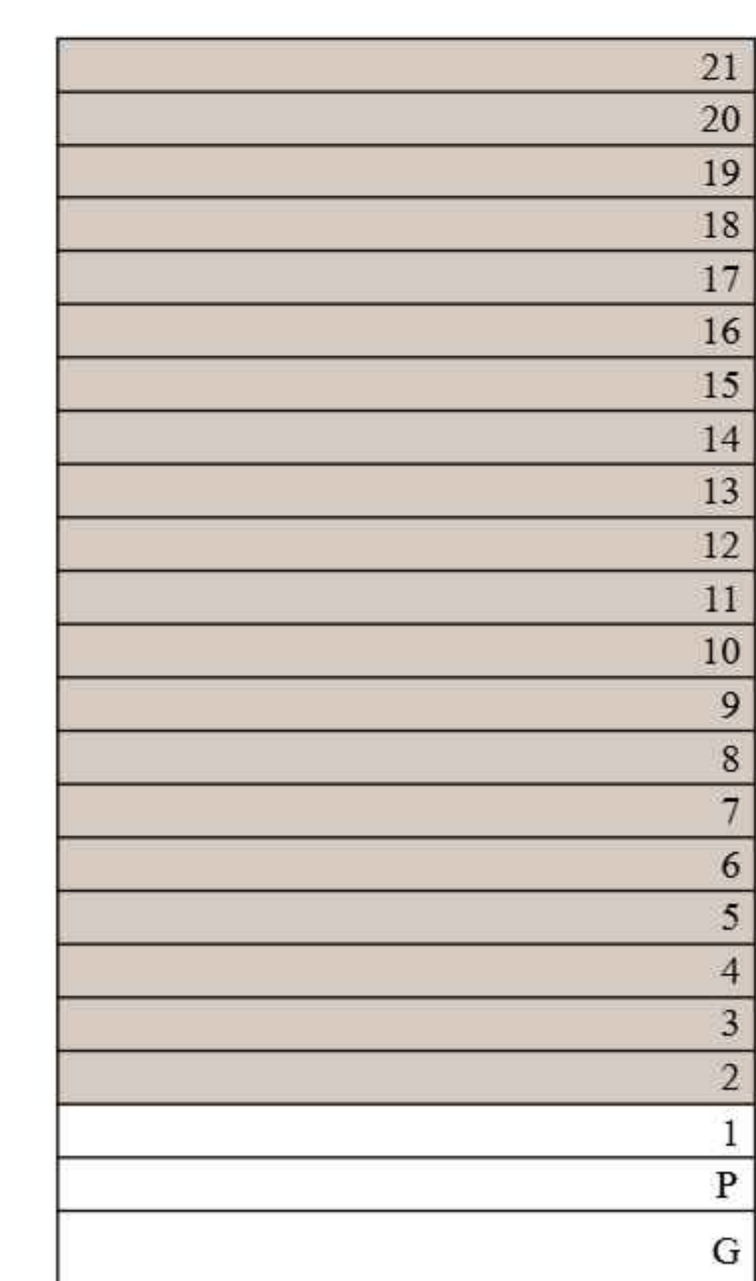

LEVEL 2 TO 21

FLOOR PLAN 1. All dimensions are in imperial and metric, and measured from finish to finish excluding construction tolerances. 2. All materials, dimensions, and drawings are approximate only. 3. Information is subject to change without notice, at developer's absolute discretion. 4. Actual area may vary from the stated area. 5. Drawings not to scale. 6. All images used are for illustrative purposes only and do not represent the actual size, features, specifications, fittings, and furnishings. 7. The developer reserves the right to make revisions / alterations, at it's absolute discretion, without any liability whatsoever.

Rosehill

DUBAI HILLS ESTATE

BLOCK A

2 BEDROOM TYPE 2C

UNITS
102

SUITE AREA	1100.39 SQ.FT.	102.23 SQ.M.
BALCONY AREA	419.79 SQ.FT.	39.00 SQ.M.
TOTAL AREA	1520.18 SQ.FT.	141.23 SQ.M.



KEY SECTION

KEY PLAN

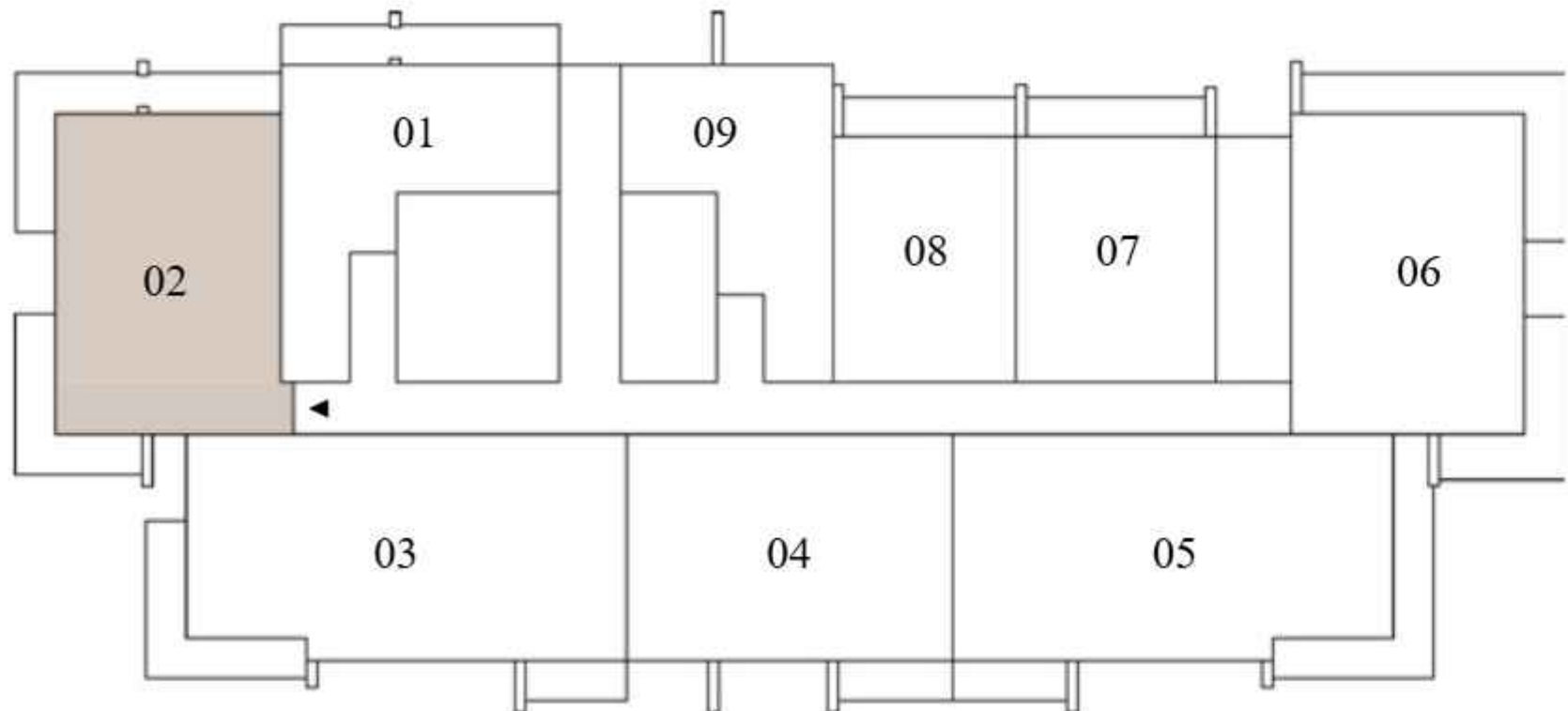
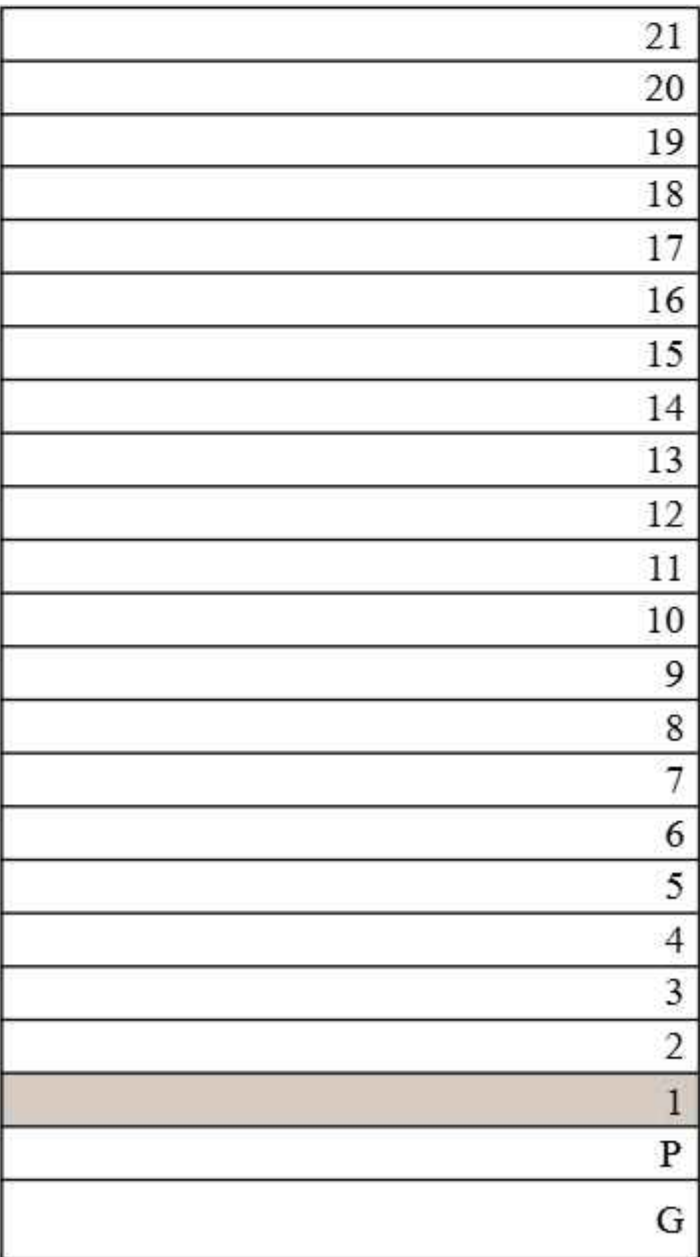

LEVEL 1

FLOOR PLAN 1. All dimensions are in imperial and metric, and measured from finish to finish excluding construction tolerances. 2. All materials, dimensions, and drawings are approximate only. 3. Information is subject to change without notice, at developer's absolute discretion. 4. Actual area may vary from the stated area. 5. Drawings not to scale. 6. All images used are for illustrative purposes only and do not represent the actual size, features, specifications, fittings, and furnishings. 7. The developer reserves the right to make revisions / alterations, at it's absolute discretion, without any liability whatsoever.

Rosehill

DUBAI HILLS ESTATE

BLOCK A

2 BEDROOM TYPE 2D

UNITS

106

SUITE AREA	1105.35 SQ.FT.	102.69 SQ.M.
BALCONY AREA	430.34 SQ.FT.	39.98 SQ.M.
TOTAL AREA	1535.69 SQ.FT.	142.67 SQ.M.



KEY SECTION

KEY PLAN

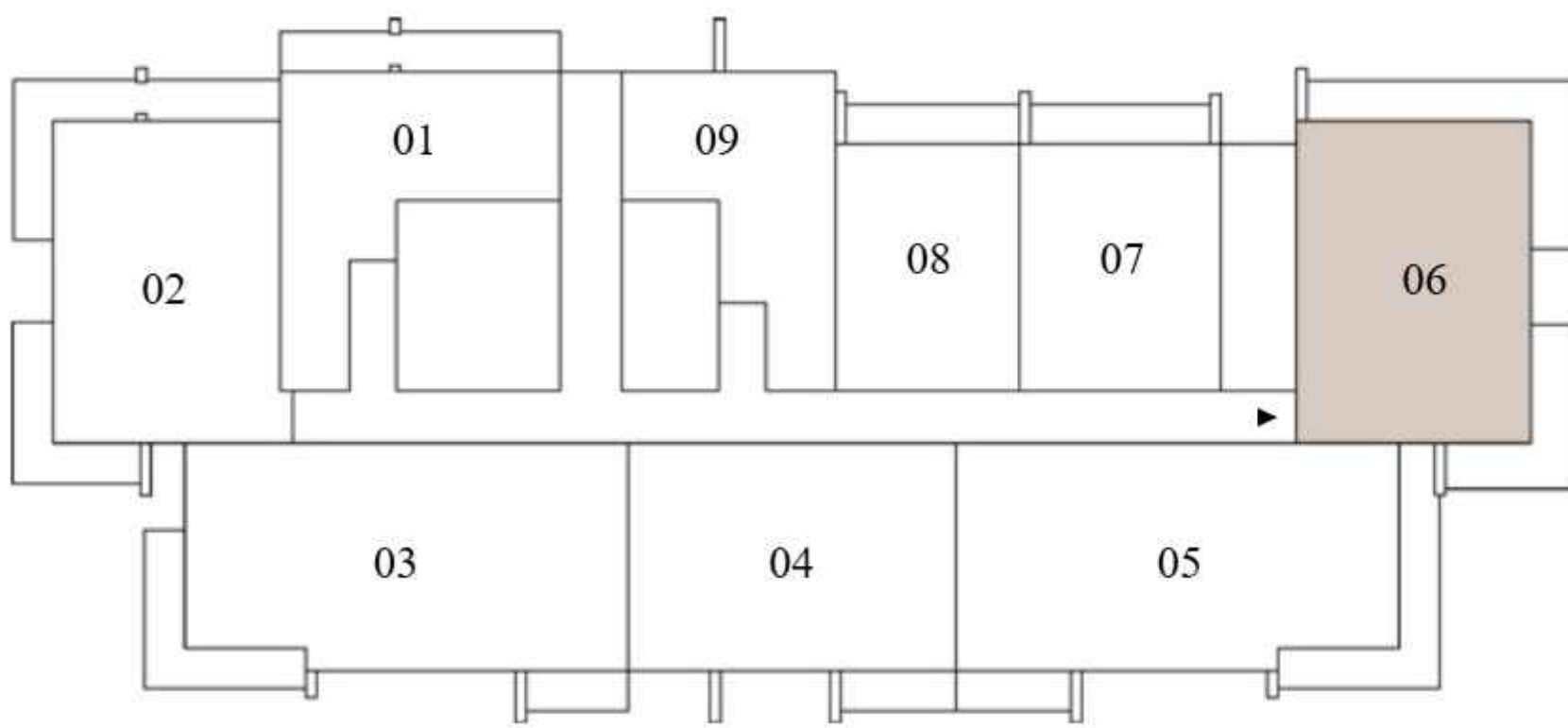
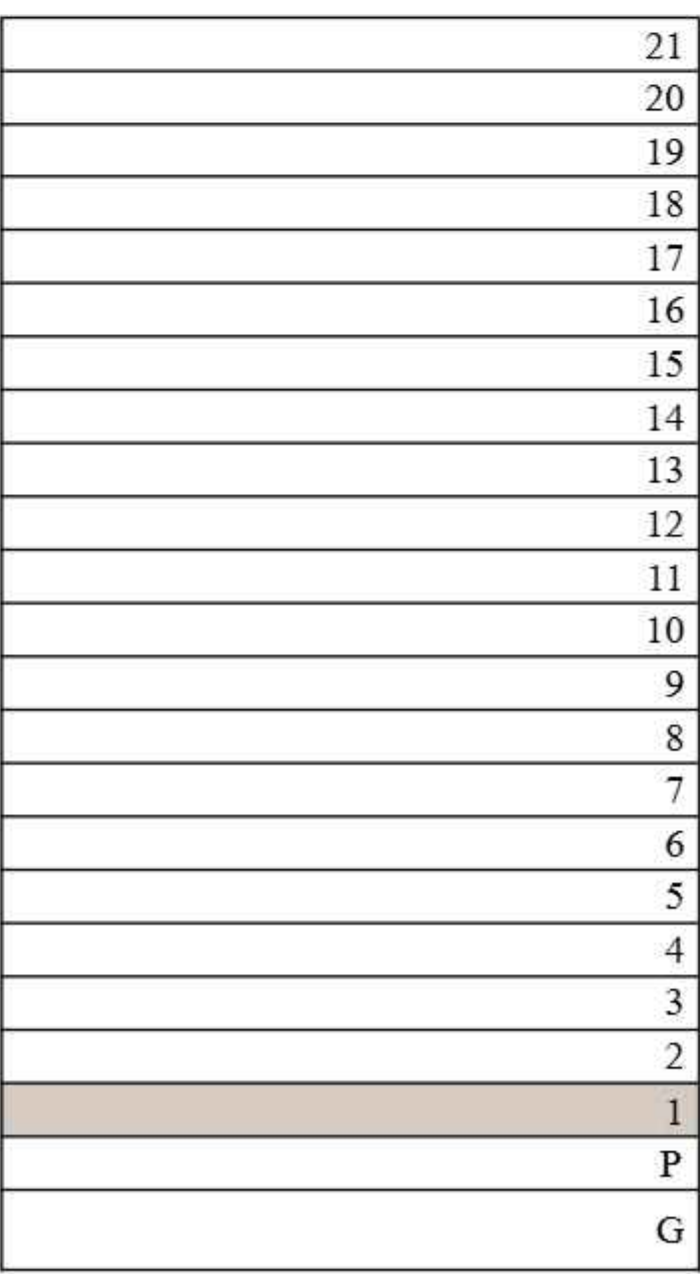
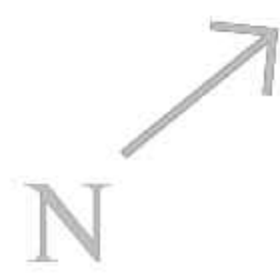

LEVEL 1

FLOOR PLAN 1. All dimensions are in imperial and metric, and measured from finish to finish excluding construction tolerances. 2. All materials, dimensions, and drawings are approximate only. 3. Information is subject to change without notice, at developer's absolute discretion. 4. Actual area may vary from the stated area. 5. Drawings not to scale. 6. All images used are for illustrative purposes only and do not represent the actual size, features, specifications, fittings, and furnishings. 7. The developer reserves the right to make revisions / alterations, at it's absolute discretion, without any liability whatsoever.

Rosehill

DUBAI HILLS ESTATE

BLOCK A

3 BEDROOM TYPE 1A

UNITS

P01, 103, 203, 303, 403, 503, 603, 703, 803, 903, 1003, 1103, 1203, 1303, 1403, 1503, 1603, 1703, 1803, 1903, 2003, 2103

SUITE AREA	1492.63 - 1493.71 SQ.FT.	138.67 - 138.77 SQ.M.
BALCONY AREA	250.15 - 291.70 SQ.FT.	23.24 - 27.10 SQ.M.
TOTAL AREA	1743.86 - 1784.33 SQ.FT.	162.01 - 165.77 SQ.M.



KEY SECTION

KEY PLAN

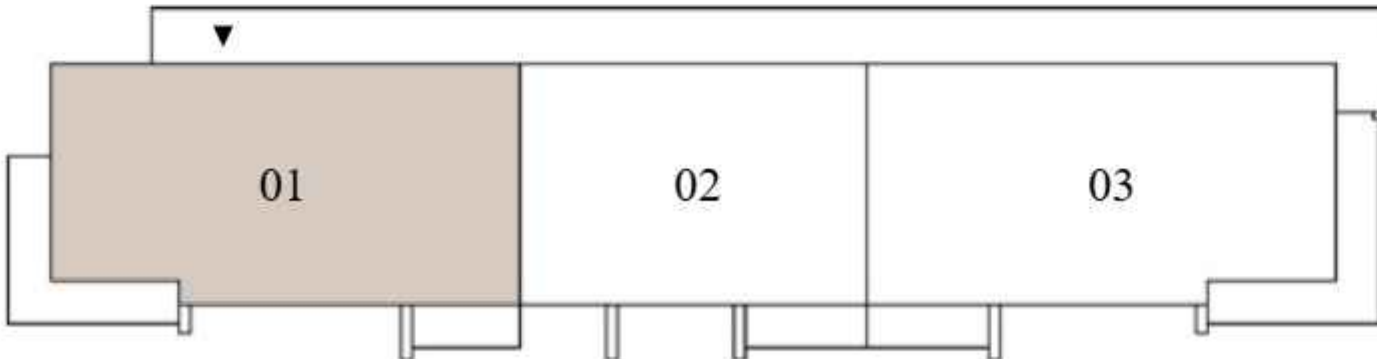
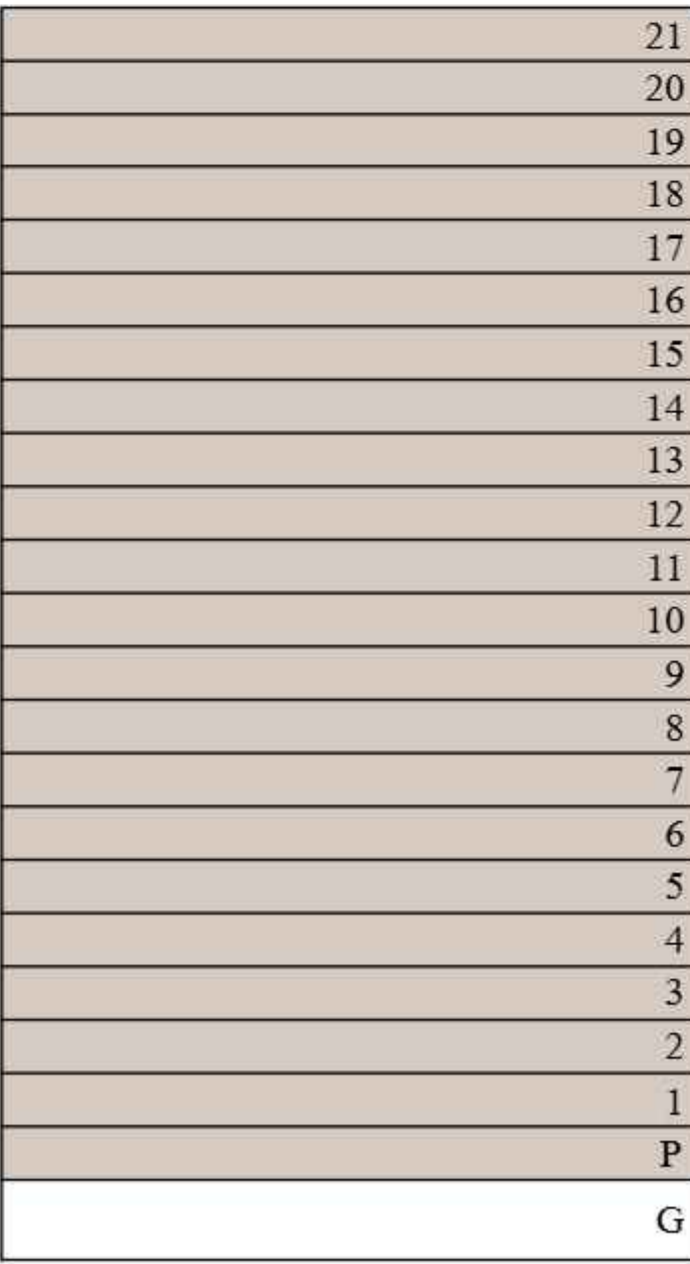
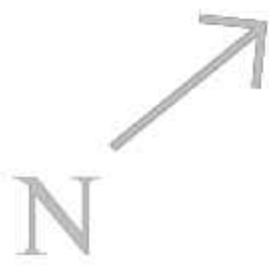

PODIUM

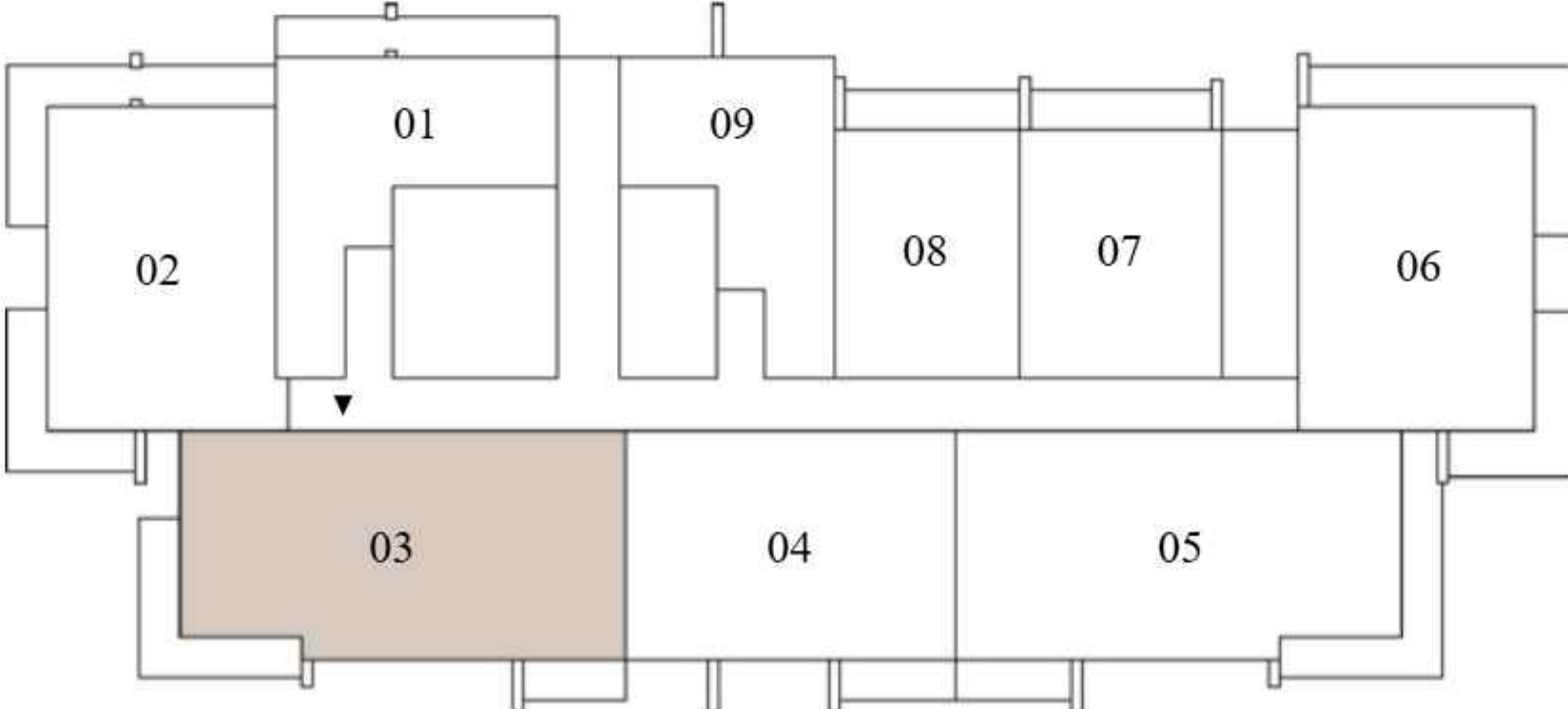

LEVEL 1

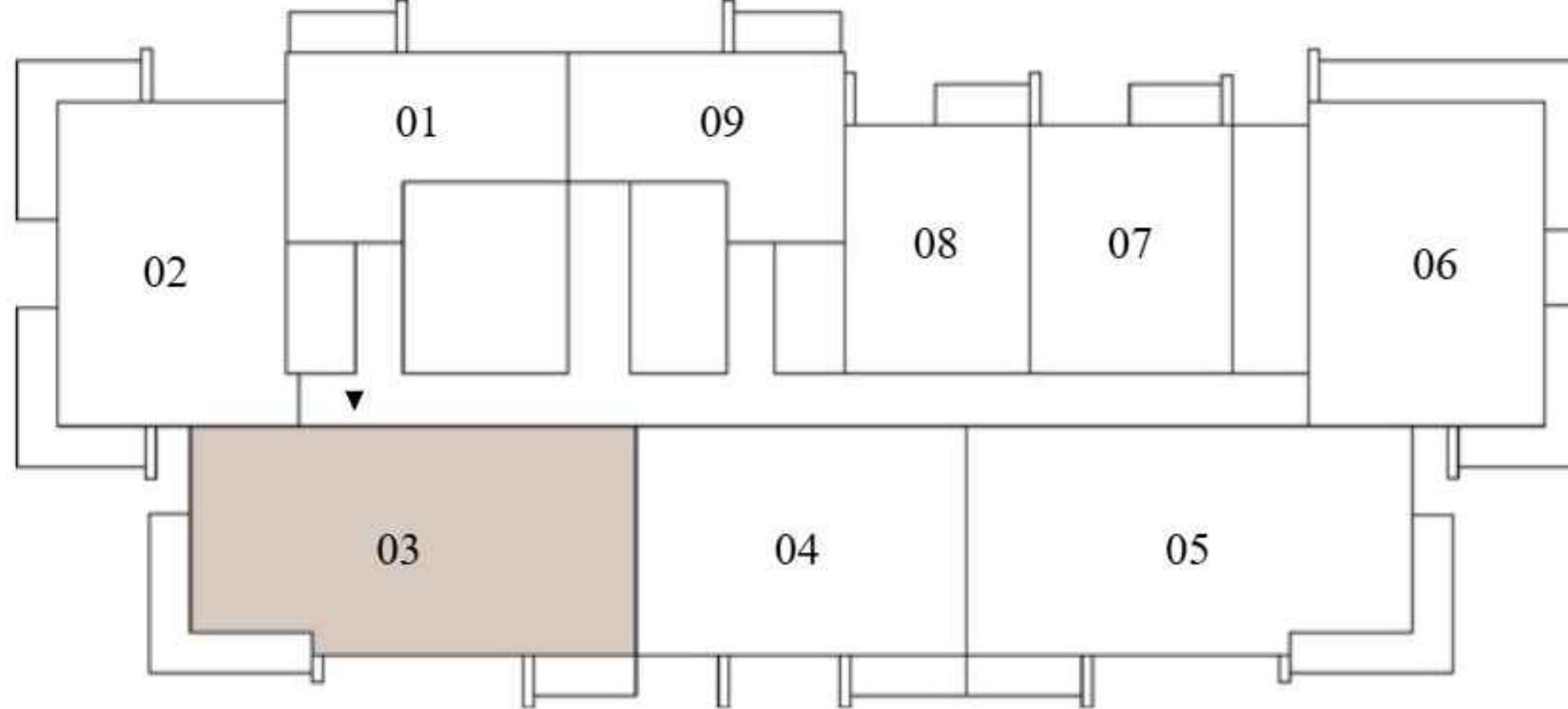

LEVEL 2 TO 21

FLOOR PLAN 1. All dimensions are in imperial and metric, and measured from finish to finish excluding construction tolerances. 2. All materials, dimensions, and drawings are approximate only. 3. Information is subject to change without notice, at developer's absolute discretion. 4. Actual area may vary from the stated area. 5. Drawings not to scale. 6. All images used are for illustrative purposes only and do not represent the actual size, features, specifications, fittings, and furnishings. 7. The developer reserves the right to make revisions / alterations, at it's absolute discretion, without any liability whatsoever.

Rosehill

DUBAI HILLS ESTATE

BLOCK A

3 BEDROOM TYPE 1B

UNITS

205, 305, 405, 505, 605, 705, 805, 905, 1005, 1105, 1205, 1305, 1405,
1505, 1605, 1705, 1805, 1905, 2005, 2105

SUITE AREA	1489.51 SQ.FT.	138.38 SQ.M.
BALCONY AREA	260.27 SQ.FT.	24.18 SQ.M.
TOTAL AREA	1749.78 SQ.FT.	162.56 SQ.M.



KEY SECTION

KEY PLAN

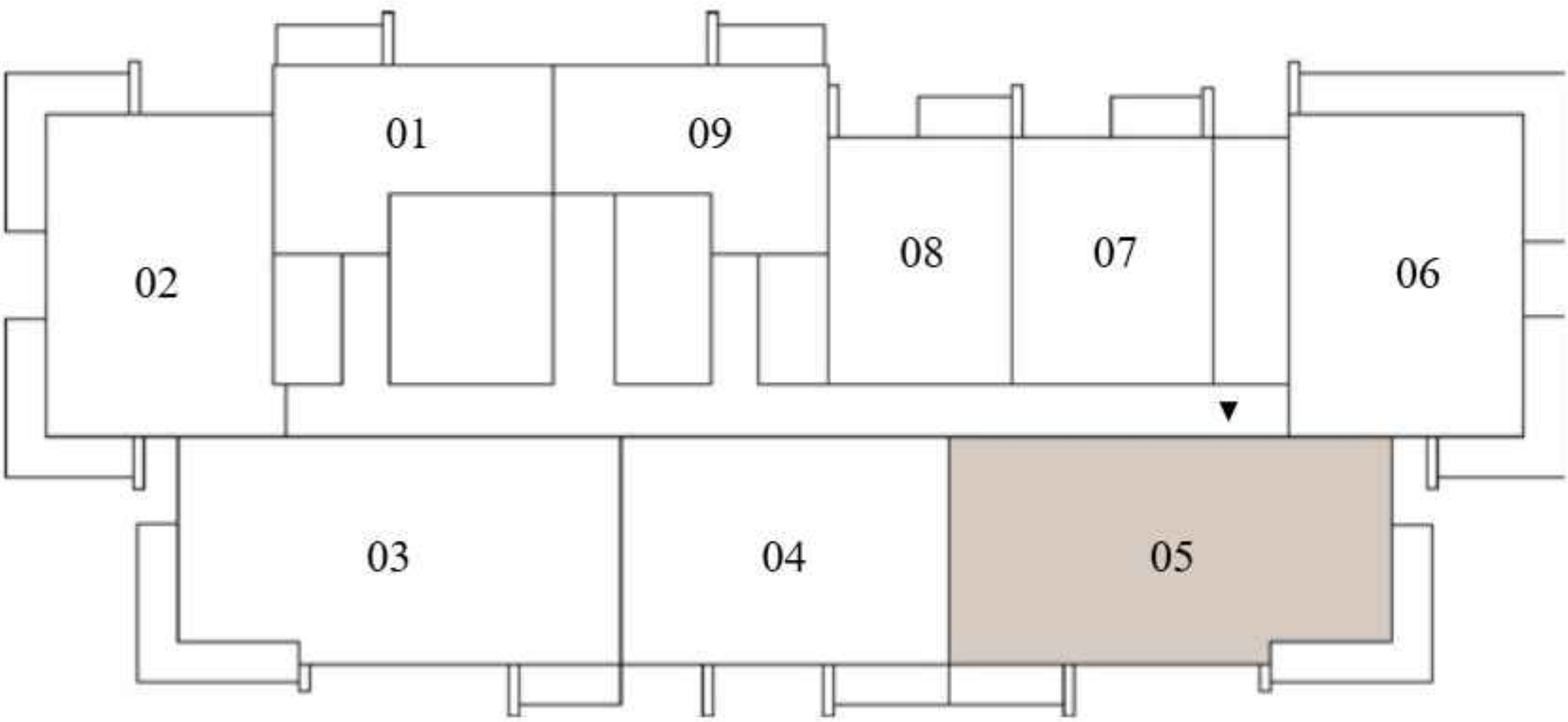
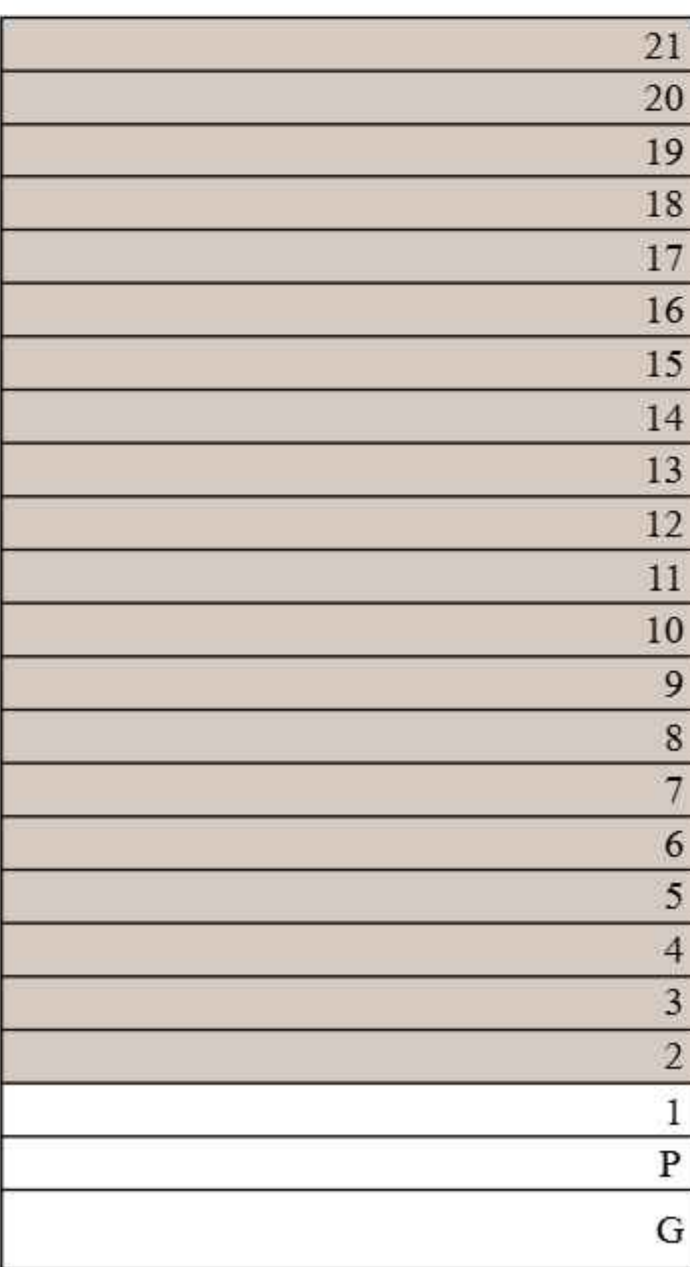

LEVEL 2 TO 21

FLOOR PLAN 1. All dimensions are in imperial and metric, and measured from finish to finish excluding construction tolerances. 2. All materials, dimensions, and drawings are approximate only. 3. Information is subject to change without notice, at developer's absolute discretion. 4. Actual area may vary from the stated area. 5. Drawings not to scale. 6. All images used are for illustrative purposes only and do not represent the actual size, features, specifications, fittings, and furnishings. 7. The developer reserves the right to make revisions / alterations, at it's absolute discretion, without any liability whatsoever.

Rosehill

DUBAI HILLS ESTATE

BLOCK A

3 BEDROOM TYPE 1C

UNITS
105

SUITE AREA	1491.77 SQ.FT.	138.59 SQ.M.
BALCONY AREA	320.87 SQ.FT.	29.81 SQ.M.
TOTAL AREA	1812.64 SQ.FT.	168.40 SQ.M.



KEY SECTION

KEY PLAN

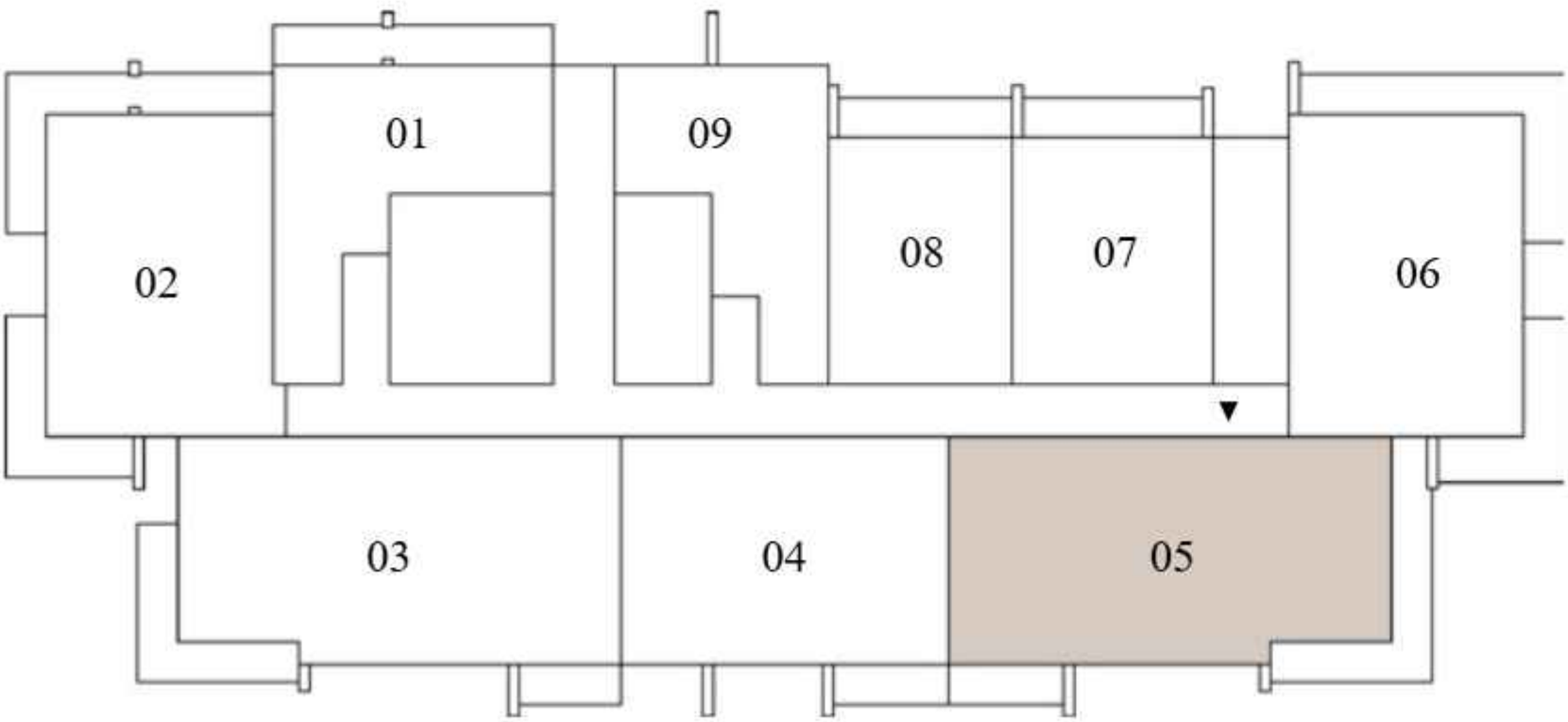
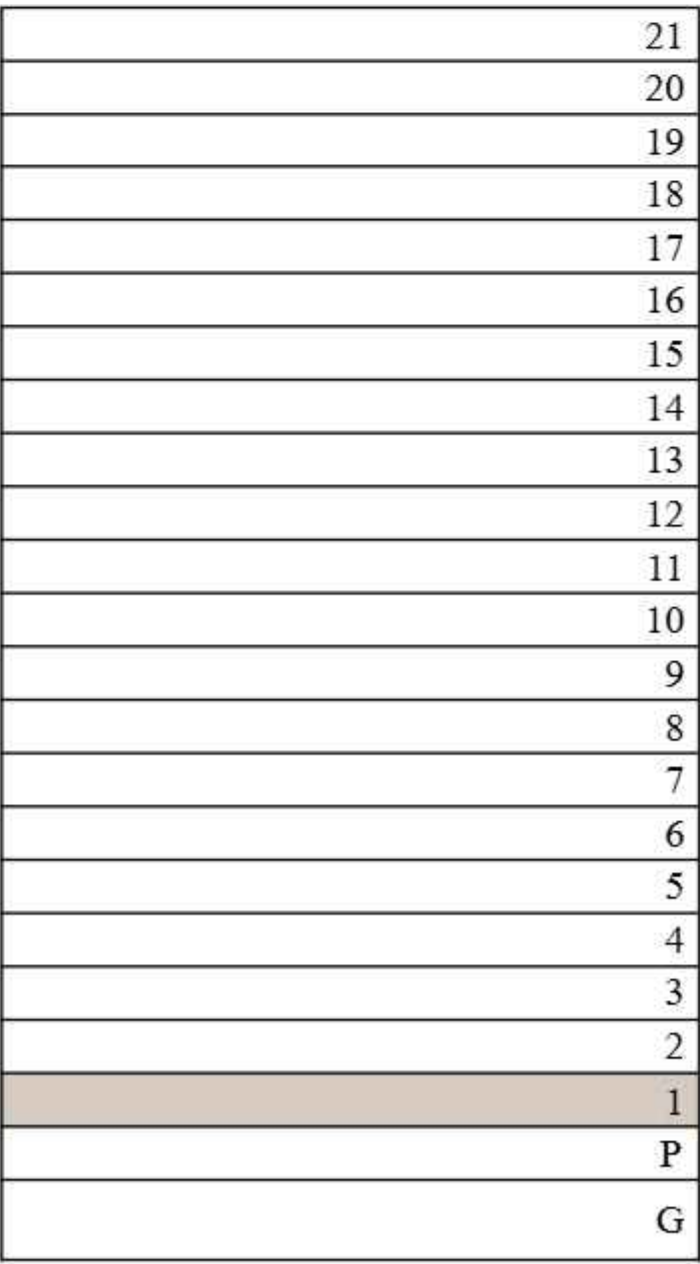

LEVEL 1

FLOOR PLAN 1. All dimensions are in imperial and metric, and measured from finish to finish excluding construction tolerances. 2. All materials, dimensions, and drawings are approximate only. 3. Information is subject to change without notice, at developer's absolute discretion. 4. Actual area may vary from the stated area. 5. Drawings not to scale. 6. All images used are for illustrative purposes only and do not represent the actual size, features, specifications, fittings, and furnishings. 7. The developer reserves the right to make revisions / alterations, at it's absolute discretion, without any liability whatsoever.

Rosehill

DUBAI HILLS ESTATE

BLOCK A

3 BEDROOM TYPE 1D

UNITS
P03

SUITE AREA	1492.63 SQ.FT.	138.67 SQ.M.
BALCONY AREA	291.70 SQ.FT.	27.10 SQ.M.
TOTAL AREA	1784.33 SQ.FT.	165.77 SQ.M.



KEY SECTION

KEY PLAN

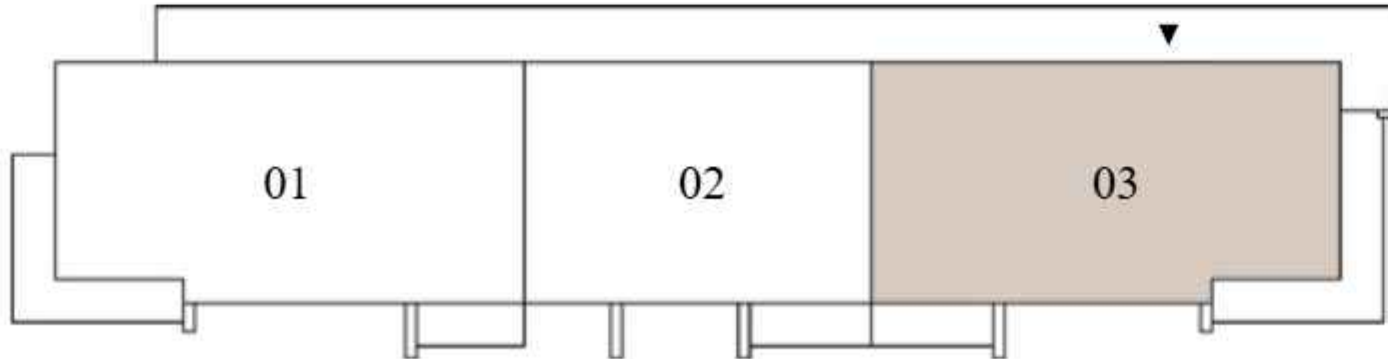
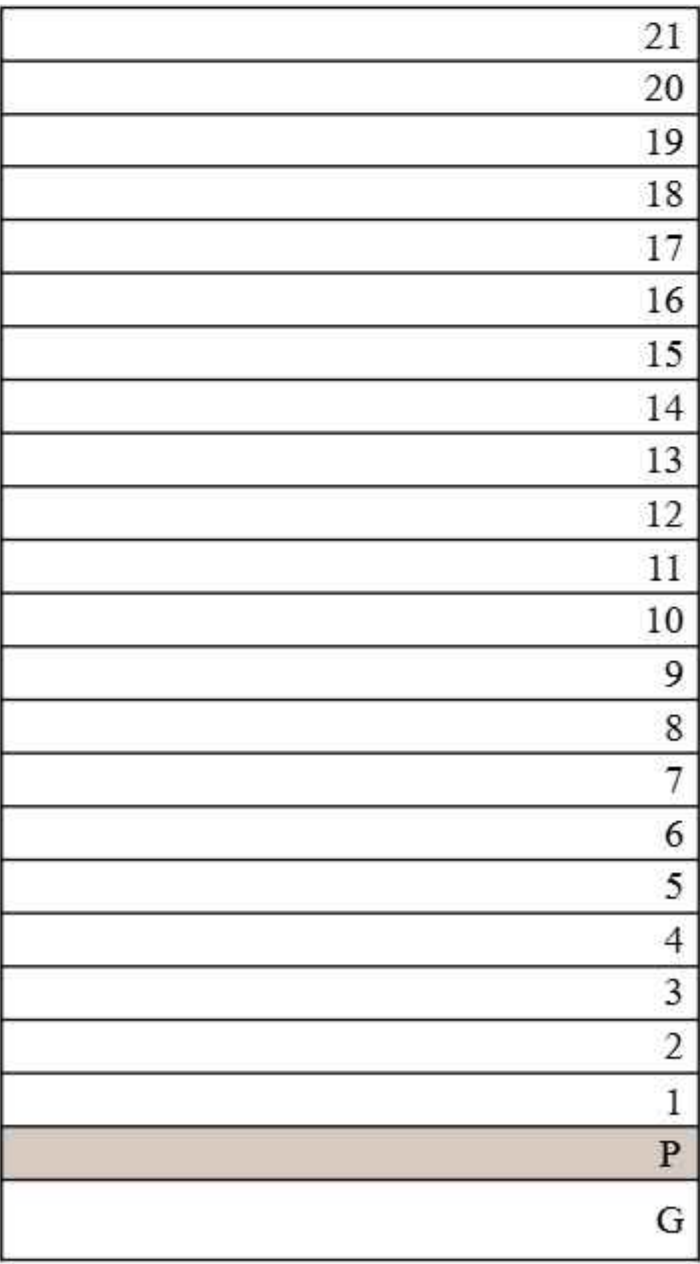

FLOOR PLAN 1. All dimensions are in imperial and metric, and measured from finish to finish excluding construction tolerances. 2. All materials, dimensions, and drawings are approximate only. 3. Information is subject to change without notice, at developer's absolute discretion. 4. Actual area may vary from the stated area. 5. Drawings not to scale. 6. All images used are for illustrative purposes only and do not represent the actual size, features, specifications, fittings, and furnishings. 7. The developer reserves the right to make revisions / alterations, at it's absolute discretion, without any liability whatsoever.

Rosehill

DUBAI HILLS ESTATE

BLOCK A

3 BEDROOM TYPE 1E

UNITS
G03

SUITE AREA	1491.99 SQ.FT.	138.61 SQ.M.
BALCONY AREA	579.85 SQ.FT.	53.87 SQ.M.
TOTAL AREA	2071.84 SQ.FT.	192.48 SQ.M.



KEY SECTION

KEY PLAN

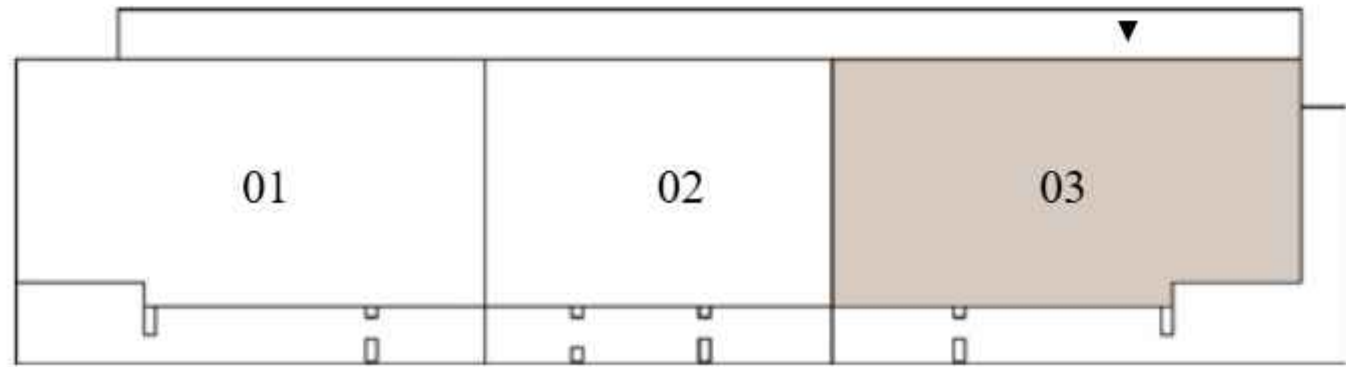
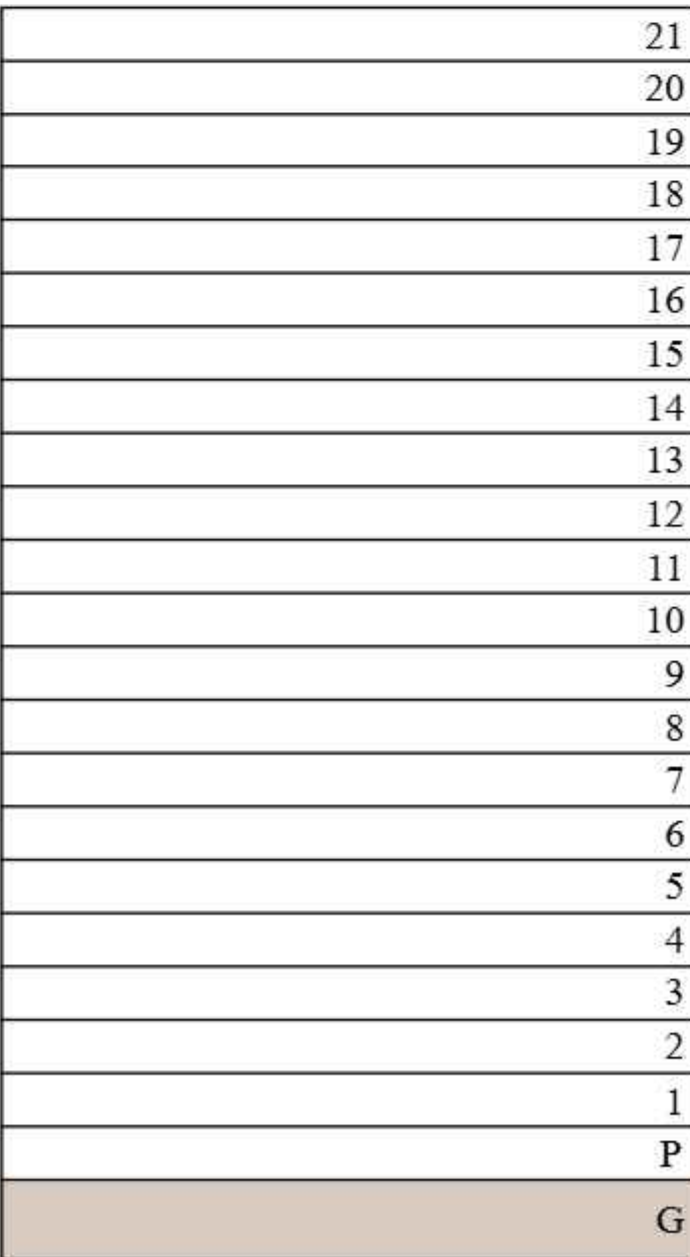
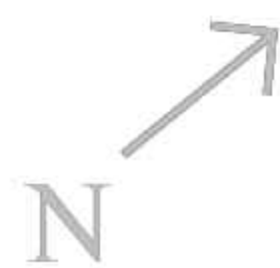

FLOOR PLAN 1. All dimensions are in imperial and metric, and measured from finish to finish excluding construction tolerances. 2. All materials, dimensions, and drawings are approximate only. 3. Information is subject to change without notice, at developer's absolute discretion. 4. Actual area may vary from the stated area. 5. Drawings not to scale. 6. All images used are for illustrative purposes only and do not represent the actual size, features, specifications, fittings, and furnishings. 7. The developer reserves the right to make revisions / alterations, at it's absolute discretion, without any liability whatsoever.

Rosehill

DUBAI HILLS ESTATE

BLOCK A

3 BEDROOM TYPE 2A

UNITS
G01

SUITE AREA	1488.97 SQ.FT.	138.33 SQ.M.
BALCONY AREA	424.85 SQ.FT.	39.47 SQ.M.
TOTAL AREA	1913.82 SQ.FT.	177.80 SQ.M.

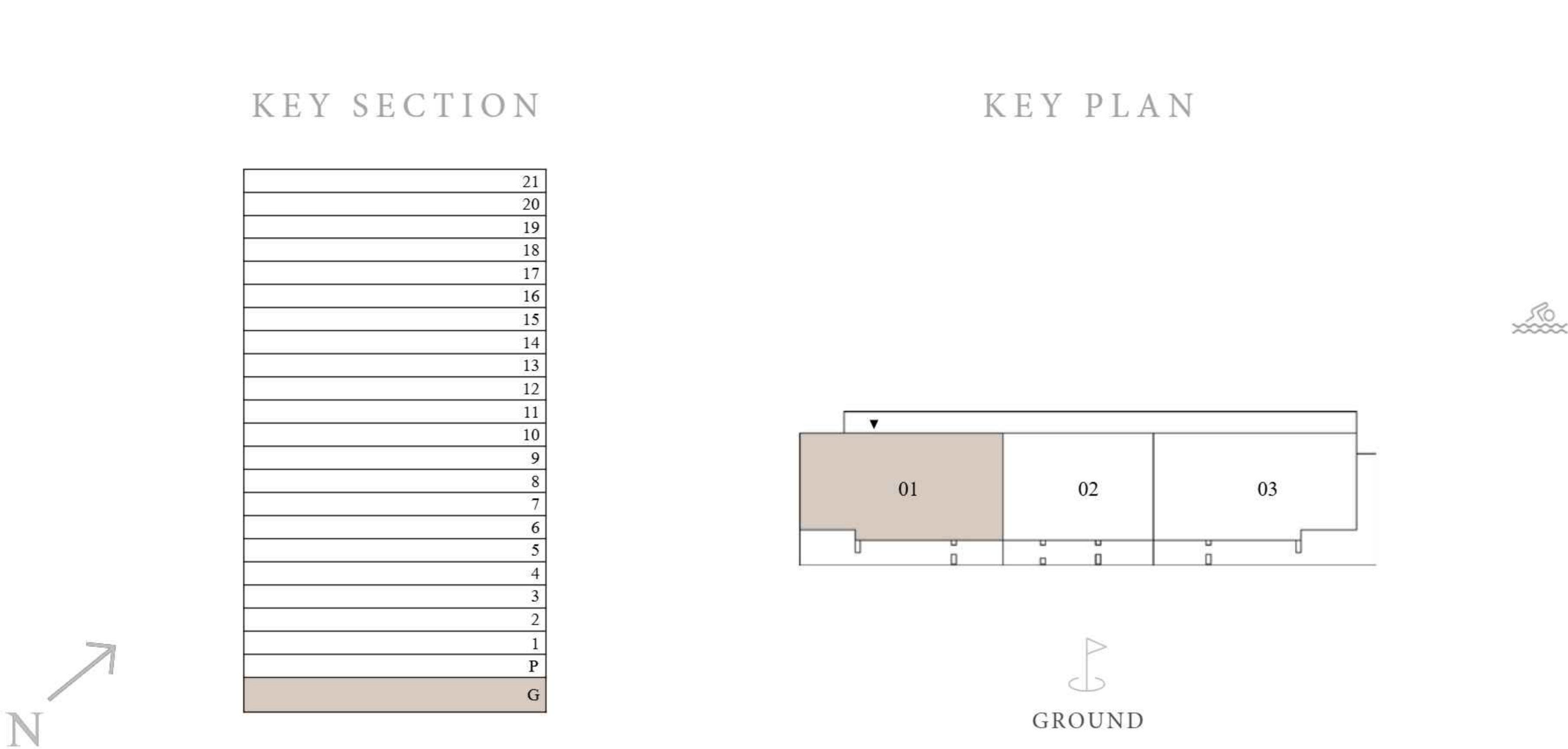

FLOOR PLAN 1. All dimensions are in imperial and metric, and measured from finish to finish excluding construction tolerances. 2. All materials, dimensions, and drawings are approximate only. 3. Information is subject to change without notice, at developer's absolute discretion. 4. Actual area may vary from the stated area. 5. Drawings not to scale. 6. All images used are for illustrative purposes only and do not represent the actual size, features, specifications, fittings, and furnishings. 7. The developer reserves the right to make revisions / alterations, at it's absolute discretion, without any liability whatsoever.



housebook Real Estate Company
since 2012 in the UAE

+971 (4) 412-5007

Managers of partnerships



Alevtina Kapustina



Svetlana Guseva

Office

Housebook Real Estate LCC

Marina Plaza, office 2502-01, Dubai, UAE

Company license: 1128098

ae.housebook.deals

partner@housebook.ae

